

CORNER RESTORATION

CORNER: C1/4 SEC. 11 TWP. 9 S. RANGE 45 E., W.M.

ORIGINAL SURVEY BY: James Hambleton, PLS

MAP OF SURVEY NO: 9-45-6

RECORDING DATE: March 28, 1973

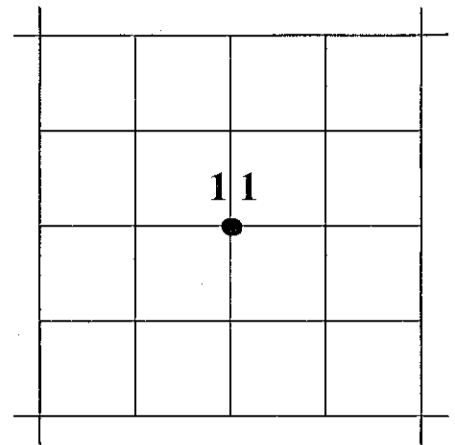

ORIGINAL DESCRIPTION: Map of Survey No. 9-45-6 is unclear as to whether or not Hambleton actually set any monument at this location. The corner is designated by a solid circle on the map, however there is no legend or narrative on the face of the map.

RESTORATION BY, STAMP AND DATE:

J.L. Hatfield, PLS

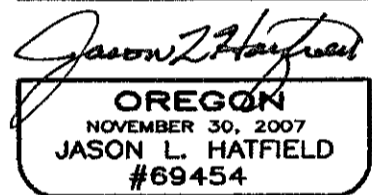
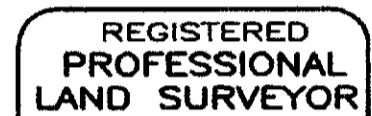

November 11, 2010

EXPIRES: 6/30/2011

EVIDENCE FOUND: I searched for monumentation at this location, and found nothing. It is unknown whether a monument was originally set and was obliterated, or if nothing was ever set.

DESCRIPTION OF MONUMENTS AND ACCESSORIES SET AND METHODS USED:

At the corner point, which falls in a pasture, I set a 5/8"x30" iron pin, 33" in the ground, with attached 2" diameter aluminum cap marked as shown.

From which I SET NEW REFERENCE POINTS:

- ▶ A 5/8"x30" iron pin, bears N44°15'E, 20.80 ft., with attached yellow plastic cap marked BENCHMARK SURVEYING
- ▶ A 5/8"x30" iron pin, bears S44°45'W, 26.61 ft., with attached yellow plastic cap marked BENCHMARK SURVEYING
- ▶ A 5/8"x30" iron pin, bears N43°07'W, 34.04 ft., with attached yellow plastic cap marked BENCHMARK SURVEYING
- ▶ A 5/8"x30" iron pin, bears N00°55'10"E, 52.82 ft., with attached yellow plastic cap marked BENCHMARK SURVEYING

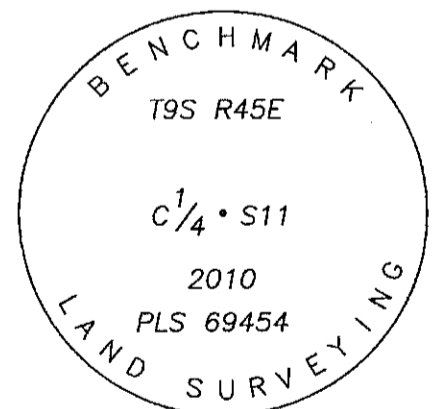

Used RTK GPS to measure the RP's.

See Record Survey No. 9-45-89

FILED Dec. 3, 2010
BAKER COUNTY SURVEYOR
SURVEY NO. 9-45-89 91