

# CORNER RESTORATION

CORNER: N1/4 SEC. 11 TWP. 9 S. RANGE 45 E., W.M.

ORIGINAL SURVEY BY: W.B. Barr, U.S. Deputy Surveyor

CONTRACT NUMBER: 355

CONTRACT DATE: June 14, 1880

**SUBSEQUENT SURVEYS:**

- ▶ Map of Survey No. 9-45-6 by James Hambleton, PLS, recorded March 28, 1973.

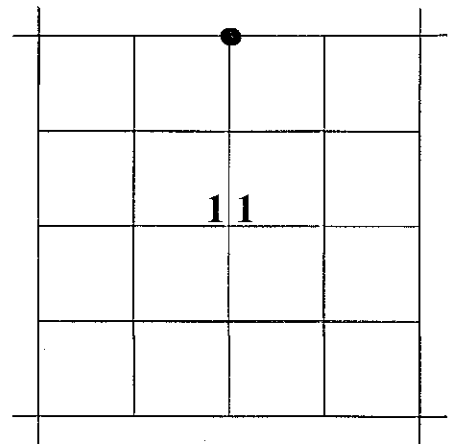

**ORIGINAL DESCRIPTION:**

40.25 Marked Basalt Rock 36x15x10 for 1/4 Sec corner, Raised mound of rock as per instructions.

42.00 Canyon Course South Ascend

- ▶ Hambleton's map states: *Used fence junction for 1/4 cor. as it checked out reasonably well.*

**RESTORATION BY, STAMP AND DATE:**

J.L. Hatfield, PLS

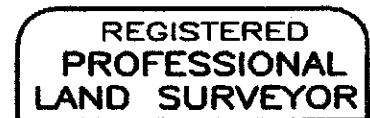

*Jason L. Hatfield*

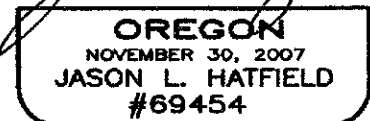

November 11, 2010

**EVIDENCE FOUND:** I found a long established fence corner with wire fences extending East, West and South. The fence corner had recently been rebuilt, and heavy equipment had been used to clear the area of blackberry bushes. There were two rock jacks containing most of the stones in the immediate area. I verified the position of the fence corner by tying the creek in the bottom of the canyon, which was 113 ft. west of the fence corner (GLO Record: 115.5 ft.). I accept the fence corner as the best available evidence of the position of the 1/4 corner.

**DESCRIPTION OF MONUMENTS AND ACCESSORIES SET AND METHODS USED:**

At the corner point: I set a 5/8"x30" iron pin, 29" in the ground, with attached 2" diameter aluminum cap marked as shown.

**From which I SET NEW REFERENCE POINTS:**

- ▶ A 5/8"x30" iron pin, bears N38°07'E, 16.31 ft., with attached yellow plastic cap marked BENCHMARK SURVEYING
- ▶ A 5/8"x30" iron pin, bears S44°28'E, 13.47 ft., with attached yellow plastic cap marked BENCHMARK SURVEYING
- ▶ A 5/8"x30" iron pin, bears S43°08'W, 11.78 ft., with attached yellow plastic cap marked BENCHMARK SURVEYING
- ▶ A 5/8"x30" iron pin, bears N44°10'W, 32.70 ft., with attached yellow plastic cap marked BENCHMARK SURVEYING

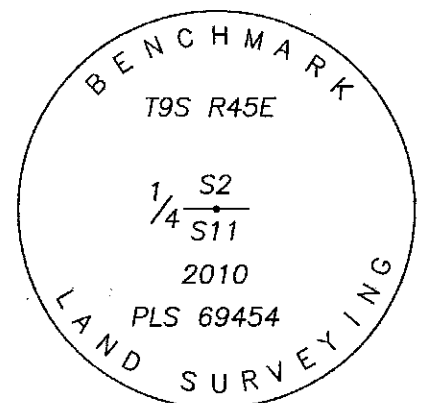

Used RTK GPS to measure the RP's.

See Record Survey No. 9-45-89

FILED Dec 3, 2010  
BAKER COUNTY SURVEYOR  
SURVEY NO. 9-45-89 90

E  
X-19