

CERTIFIED RECORD OF LAND CORNER MONUMENTATION

CORNER: NW CORNER SECTION 6, TWP. 10 S., RANGE 44 E., W.M.

ORIGINAL SURVEY BY: N.O. Walden, U.S. Deputy Surveyor

CONTRACT NUMBER: 198

CONTRACT DATE: July 15, 1873

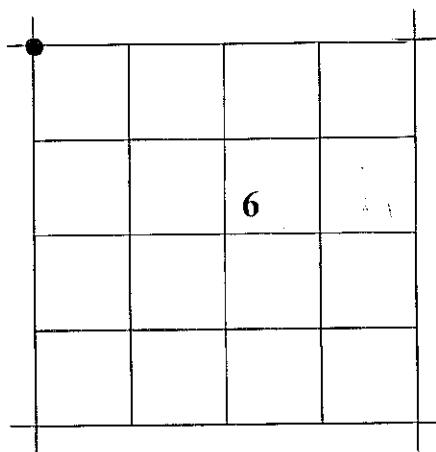

ORIGINAL DESCRIPTION: Set basalt rock 18x10x8 ins, 8 in in ground for corner to Townships 9 & 10 S. R. 43 & 44 E. in mound of rocks.

EVIDENCE FOUND: I found a basalt stone 18"x9"x7" firmly set 12" in the ground in a small mound of stones. The stone was oriented properly, marked with 6 grooves on the North face, 6 grooves on the East face, 6 grooves on the South face and 6 grooves on the West face. The stone was also lightly marked on the top with an "X". I also found an unrecorded 1/2" galvanized iron pipe 40" long, driven North and alongside the marked stone. The pipe was marked with 6 bars on the North side and 6 bars on the South side. I accept the position of the found marked stone for the township corner.

DESCRIPTION OF MONUMENTS AND ACCESSORIES SET AND METHODS USED:

At the corner point, I drove the found iron pipe (inverted) down below ground, and set a 1 1/2"x30" galvanized iron pipe with attached 2 1/2" brass cap, 28" in the ground, over the top of the 1/2" pipe. I deposited the marked stone inverted, north and alongside. Raised a mound of stone and earth, 2 foot diameter to the top of cap. Brass cap marked as shown below.

From which, I SET THE FOLLOWING REFERENCE POINTS:

- ▶ A 5/8"x30" iron pin bears N.45°09'E., 24.98 ft. with attached yellow plastic cap marked BENCHMARK SURVEYING.
- ▶ A 5/8"x30" iron pin bears S.44°36'E., 24.98 ft. with attached yellow plastic cap marked BENCHMARK SURVEYING.
- ▶ A 5/8"x30" iron pin bears S.44°57'W., 24.97 ft. with attached yellow plastic cap marked BENCHMARK SURVEYING.
- ▶ A 5/8"x30" iron pin bears N.45°07'W., 24.95 ft. with attached yellow plastic cap marked BENCHMARK SURVEYING.

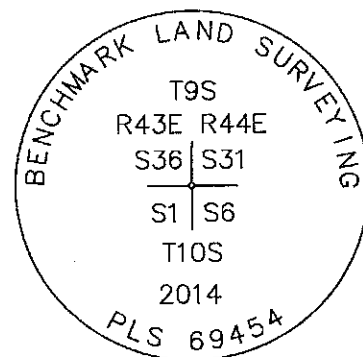

Used RTK GPS to measure the reference points. Bearings are based on Record Map of Survey No. 10-44-2.

RESTORATION BY, STAMP AND DATE:

Work performed October 3, 2014 by:

Jason L. Hatfield, PLS and
Eithen T. Hatfield

Benchmark Land Surveying, Inc.
2101 Main Street, Suite 223
Baker City, OR 97814
(800) 699-0516

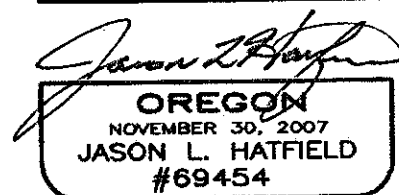
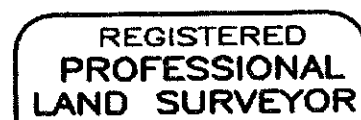

EXPIRES: 6/30/2015

FILED October 23, 2014

BAKER COUNTY SURVEYOR

SURVEY NO. 9-43-7

10-43-1
9-44-11
10-44-12