

CERTIFIED RECORD OF LAND CORNER MONUMENTATION

CORNER: EAST 1/4 COR. SEC. 7, TWP. 9 S., RANGE 41 E., W.M.

ORIGINAL SURVEY BY: W.B. Barr, U.S. Deputy Surveyor

CONTRACT NUMBER: 443

CONTRACT DATE: May 29, 1882

SUBSEQUENT SURVEYS:

- ▶ Mineral Survey 317, surveyed June 20-23, 1896 by Arthur Philbrick, U.S. Deputy Mineral Surveyor
- ▶ Mineral Survey 524, surveyed April 30, 1903 by Charles M. Foster, U.S. Deputy Mineral Surveyor

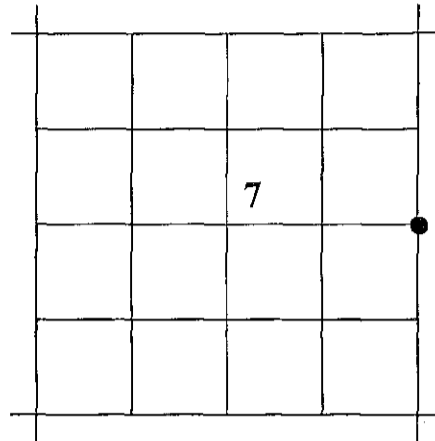

ORIGINAL DESCRIPTION: 40.00 Ridge course NW, Set basalt rock 12x10x6 ins, 8 inches in ground for 1/4 Sec corner, marked 1/4 on the West side, dug pits 18x18x12 ins, 5 1/2 ft. dist N&S of stone and raised mound of earth 1 1/2 ft high 3 1/2 ft. base alongside

- ▶ Mineral Survey 317 shows a total distance between the SE Corner Section 7 and the E1/4 Corner Section 7 to be 2640 ft., and shows the relationship of the claim corners to the E1/4 Corner.
- ▶ Mineral Survey 524 shows a total distance between the NE Corner Section 7 and the E1/4 Corner Section 7 to be 2690 feet.

EVIDENCE FOUND: After a diligent search, I found no remaining evidence of the original monument. However, I did find monuments at Corner No. 4 of the North Star Quartz Claim and at the Northwesternly end of the lode line of the North Star Quartz Claim. Utilizing the record data from Mineral Survey 317, I reestablish the position of the East 1/4 Corner by distance-distance intersect. This position is harmoniously related to found monuments at the NE and SE Corners of Section 7.

DESCRIPTION OF MONUMENTS AND ACCESSORIES SET AND METHODS USED:

At the corner point, I set a 1 1/2"x30" galvanized iron pipe with attached 2 1/2" brass cap 28" in the ground. Raised a mound of stone and earth, 2 foot diameter to the top of cap. Brass cap marked as shown below.

From which, I SET THE FOLLOWING REFERENCE POINTS:

- ▶ A 5/8"x15" iron pin bears N.55°46'E., 19.17 ft. with attached yellow plastic cap marked BENCHMARK SURVEYING.
- ▶ A 5/8"x15" iron pin bears S.37°38'E., 19.95 ft. with attached yellow plastic cap marked BENCHMARK SURVEYING.
- ▶ A 5/8"x15" iron pin bears S.64°37'W., 18.08 ft. with attached yellow plastic cap marked BENCHMARK SURVEYING.
- ▶ A 5/8"x15" iron pin bears N.38°05'W., 26.67 ft. with attached yellow plastic cap marked BENCHMARK SURVEYING.

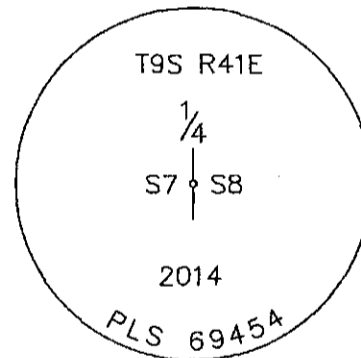

Used RTK GPS to measure the reference points. Bearings are based on Geodetic North obtained by GPS observation at the SW Corner Section 7, T.9S., R.41E.

RESTORATION BY, STAMP AND DATE:

Work performed June 26, 2014 by:
Jason L. Hatfield, PLS and
Michael C. Springer, PLS

Benchmark Land Surveying, Inc.
2101 Main Street, Suite 223
Baker City, OR 97814
(800) 699-0516

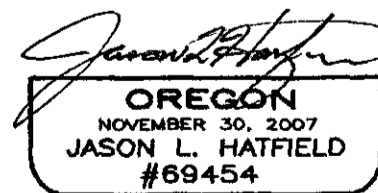
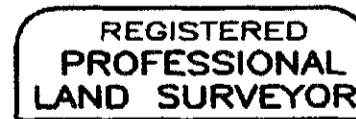

EXPIRES: 6/30/2015

FILED July 2, 2014
BAKER COUNTY SURVEYOR
SURVEY NO. 9-41-39