

CERTIFIED RECORD OF LAND CORNER MONUMENTATION

CORNER: CENTER 1/4 COR. SEC. 7, TWP. 9 S., RANGE 41 E., W.M.

ORIGINAL SURVEY BY: NOT

CONTRACT NUMBER: PREVIOUSLY

CONTRACT DATE: ESTABLISHED

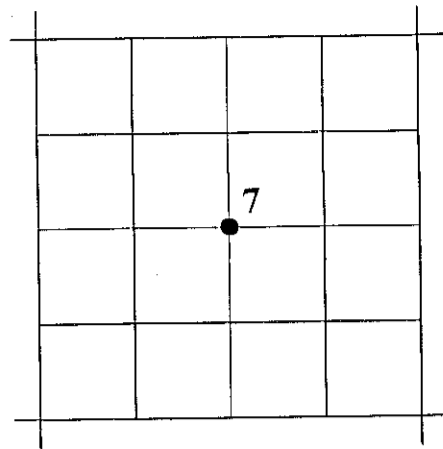

ORIGINAL DESCRIPTION: NONE

EVIDENCE FOUND: NONE

DESCRIPTION OF MONUMENTS AND ACCESSORIES SET AND METHODS USED:

At the corner point, as determined by survey, I set a 5/8"x30" iron pin with attached 2" aluminum cap 29" in the ground. Surrounded the pin with a small mound of rocks and drove a steel fence post nearby. The cap is marked as shown below.

From which, I SET THE FOLLOWING REFERENCE POINTS:

- ▶ A 5/8"x15" iron pin bears N.63°27'E., 20.37 ft. with attached yellow plastic cap marked BENCHMARK SURVEYING.
- ▶ A 5/8"x15" iron pin bears S.47°42'E., 16.20 ft. with attached yellow plastic cap marked BENCHMARK SURVEYING.
- ▶ A 5/8"x15" iron pin bears S.39°52'W., 15.75 ft. with attached yellow plastic cap marked BENCHMARK SURVEYING.
- ▶ A 5/8"x15" iron pin bears N.59°22'W., 14.59 ft. with attached yellow plastic cap marked BENCHMARK SURVEYING.

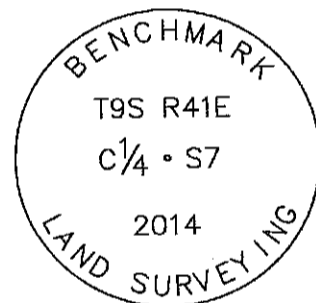

Used RTK GPS to measure the reference points. Bearings are based on Geodetic North obtained by GPS observation at the SW Corner Section 7, T.9S., R.41E.

RESTORATION BY, STAMP AND DATE:

Work performed June 26, 2014 by:
Jason L. Hatfield, PLS and
Michael C. Springer, PLS

Benchmark Land Surveying, Inc.
2101 Main Street, Suite 223
Baker City, OR 97814
(800) 699-0516

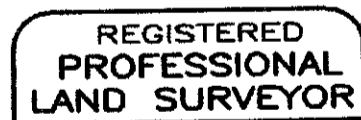

JASON L. HATFIELD

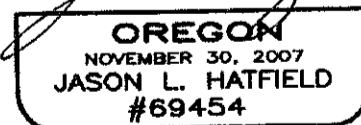

EXPIRES: 6/30/2015

FILED July 2, 2014
BAKER COUNTY SURVEYOR
SURVEY NO. 9-41-38