

# CERTIFIED RECORD OF LAND CORNER MONUMENTATION

**CORNER:** NORTH 1/4 COR. SEC. 7, TWP. 9 S., RANGE 41 E., W.M.

**ORIGINAL SURVEY BY:** W.B. Barr, U.S. Deputy Surveyor

**CONTRACT NUMBER:** 443

**CONTRACT DATE:** May 29, 1882

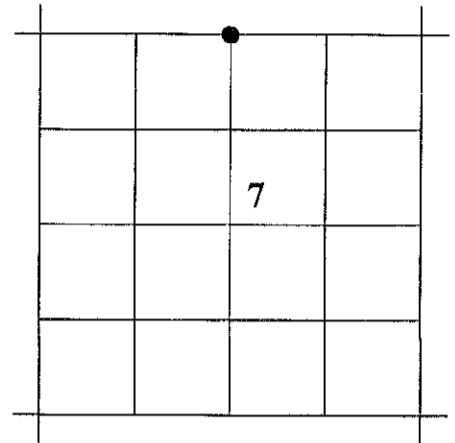

**ORIGINAL DESCRIPTION:** 39.48 Set basalt rock 18x8x6 ins, 12 inches in ground for 1/4 Sec corner, marked 1/4 on the North side dug pits 18x18x12 ins, 5 1/2 ft. dist E&W of stone and raised mound of earth 1 1/2 ft high 3 1/2 ft. base alongside

**EVIDENCE FOUND:** I found a basalt stone 18"x12"x4" set upright and firmly 9" in the ground. I found 3 faint chisle marks on the north face, which were illegible. There was no remaining evidence of the pits. W.B. Barr's field notes contain a topo call for a ridge 8.50 chains (561 feet) West of the quarter corner. Although not very prominent, I located what I believe to be the top of the ridge, which is 550 feet West of the found stone. This stone also fits very well in relation to the found, accepted monument at the Northwest Section corner (see Record Map of Survey filed in conjunction with this monumentation sheet). I accept the position of the found marked stone for the quarter corner.

**DESCRIPTION OF MONUMENTS AND ACCESSORIES SET AND METHODS USED:**

At the corner point, I set a 1 1/2"x30" galvanized iron pipe with attached 2 1/2" brass cap 28" in the ground. Deposited original marked stone upright, east and alongside iron pipe. Raised a mound of stone and earth, 2 foot diameter to the top of cap. Brass cap marked as shown below.

**From which, I SET THE FOLLOWING REFERENCE POINTS:**

- ▶ A 5/8"x15" iron pin bears N.76°20'E., 20.04 ft. with attached yellow plastic cap marked BENCHMARK SURVEYING.
- ▶ A 5/8"x15" iron pin bears S.33°37'E., 21.23 ft. with attached yellow plastic cap marked BENCHMARK SURVEYING.
- ▶ A 5/8"x15" iron pin bears S.67°50'W., 17.69 ft. with attached yellow plastic cap marked BENCHMARK SURVEYING.
- ▶ A 5/8"x15" iron pin bears N.32°44'W., 23.90 ft. with attached yellow plastic cap marked BENCHMARK SURVEYING.



Used RTK GPS to measure the reference points. Bearings are based on Geodetic North obtained by GPS observation at the SW Corner Section 7, T.9S., R.41E.

**RESTORATION BY, STAMP AND DATE:**

Work performed June 26, 2014 by:

Jason L. Hatfield, PLS and  
Michael C. Springer, PLS

Benchmark Land Surveying, Inc.  
2101 Main Street, Suite 223  
Baker City, OR 97814  
(800) 699-0516

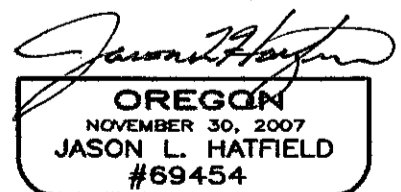
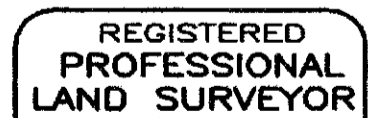

EXPIRES: 6/30/2015

FILED July 2, 2014  
BAKER COUNTY SURVEYOR  
SURVEY NO. 9-41-35