

**CERTIFIED RECORD OF LAND CORNER MONUMENTATION**

**CORNER:** WEST 1/16 COR. SEC. 7, TWP. 9 S., RANGE 41 E., W.M.

**ORIGINAL SURVEY BY:** NOT

**CONTRACT NUMBER:** PREVIOUSLY

**CONTRACT DATE:** ESTABLISHED

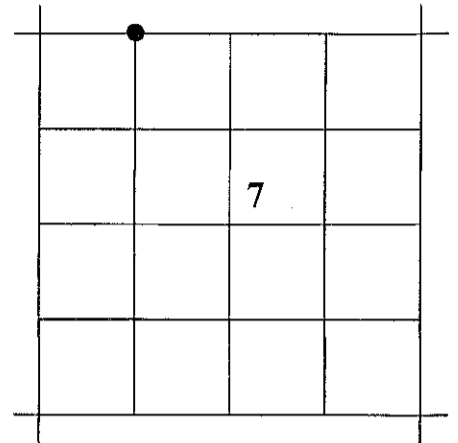

**ORIGINAL DESCRIPTION:** NONE

**EVIDENCE FOUND:** NONE

**DESCRIPTION OF MONUMENTS AND ACCESSORIES SET AND METHODS USED:**

At the corner point, as determined by survey, I set a 5/8"x30" iron pin with attached 2" aluminum cap 29" in the ground. Surrounded the pin with a small mound of rocks and drove a steel fence post nearby. The cap is marked as shown below.

**From which, I SET THE FOLLOWING REFERENCE POINTS:**

- ▶ A 5/8"x15" iron pin bears S.24°23'E., 55.03 ft. with attached yellow plastic cap marked BENCHMARK SURVEYING.
- ▶ A 5/8"x15" iron pin bears S.43°38'W., 30.34 ft. with attached yellow plastic cap marked BENCHMARK SURVEYING.

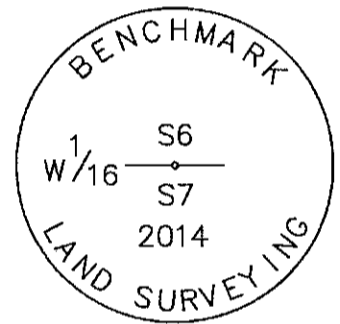

Used RTK GPS to measure the reference points. Bearings are based on Geodetic North obtained by GPS observation at the SW Corner Section 7, T.9S., R.41E.

**RESTORATION BY, STAMP AND DATE:**

Work performed June 26, 2014 by:  
Jason L. Hatfield, PLS and  
Michael C. Springer, PLS

Benchmark Land Surveying, Inc.  
2101 Main Street, Suite 223  
Baker City, OR 97814  
(800) 699-0516

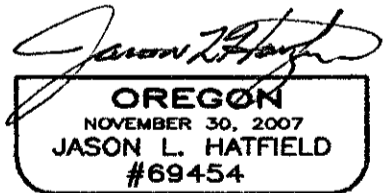
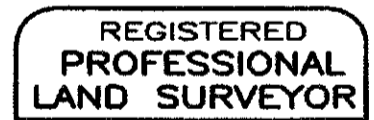

EXPIRES: 6/30/2015

FILED July 2, 2014  
BAKER COUNTY SURVEYOR  
SURVEY NO. 9-41-34