

BASIS OF BEARING
 Idaho Power Company Survey #36D-53187, between the S.E. and S.W. corners of the approx. 10 acre microwave site parcel.

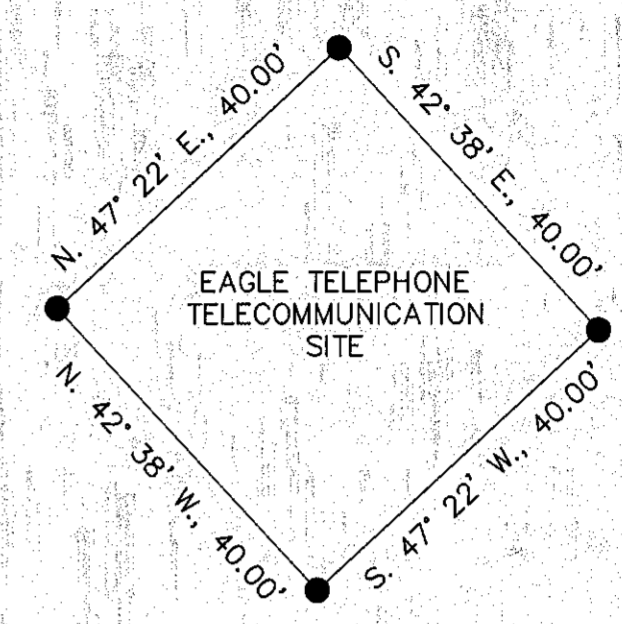

DETAIL
 SCALE: 1" = 20'

NARRATIVE

The purpose of this survey, ordered by Pat Lattin of Eagle Telephone Systems, Inc., is to mark upon the ground, with proper monumentation, the boundary corners of property leased for a telecommunication site.

LEGEND

- Set 5/8" rebar with plastic cap marked "HANLEY ENGR. PLS 1817".
- Found monument with yellow plastic cap marked "I.P. CO." set by Idaho Power Co. survey dated 7-14-98. Idaho Power Company Survey #36D-53187.
- () Data from Idaho Power Co. Survey #36D-53187.

REFERENCES

Idaho Power Co. survey with the vault number of 36D-53187. Survey was prepared by Sharp & Smith, Inc. of Boise, Idaho.

REGISTERED PROFESSIONAL LAND SURVEYOR
Thomas J. Hanley
OREGON
 JULY 13, 1979
THOMAS J. HANLEY
 1817

Renews June 30, 2001

MAP OF SURVEY
 SW 1/4 OF LOT 2, SEC. 31,
 T. 9 S., R. 41 E., W.M.
 BAKER COUNTY, OREGON

Surveyed Dec. 16, 2000
 through March 19, 2001
 for Eagle Telephone Systems, Inc.
 Scales as shown

HANLEY ENGINEERING, INC.
 2043 MAIN STREET
 BAKER CITY, OREGON