

# BASIS OF BEARING

True geodetic North at the corner common to Sections 8, 9, 16 and 17, Township 9 South, Range 40 East of the Willamette Meridian, as determined by GPS observation

SCALE: 1"=50'

## LEGEND

- Found monument as described
- ⊙ Found 5/8" iron pin in monument box, set by Survey Number 9-40-352
- Found 5/8" iron pin with plastic cap marked PARAMETRIX LS 84595, set by Survey Number 9-40-807
- ◆ Found 5/8" iron pin with plastic cap marked GOCHNOUR PLS 94710
- ▲ Found unrecorded PK Nail
- Set 5/8" iron pin with plastic cap marked BGB SURVEY MARKER
- Set lead plug with brass screw and washer marked OPLS 83571
- Centerline
- ( ) Record measurement as per Deed B02 26 0156 (Original description of Parcels within Baker Towne Square)
- [ ] Record measurement as per Survey Number 9-40-807

## REFERENCE MATERIAL

Survey Number 9-40-25BC  
 Survey Number 9-40-352  
 Survey Number 9-40-755  
 Survey Number 9-40-807

### DEED REFERENCES

B22 07 0228  
 B21 38 0321  
 B21 09 0128  
 B02 25 0286  
 B02 26 0156

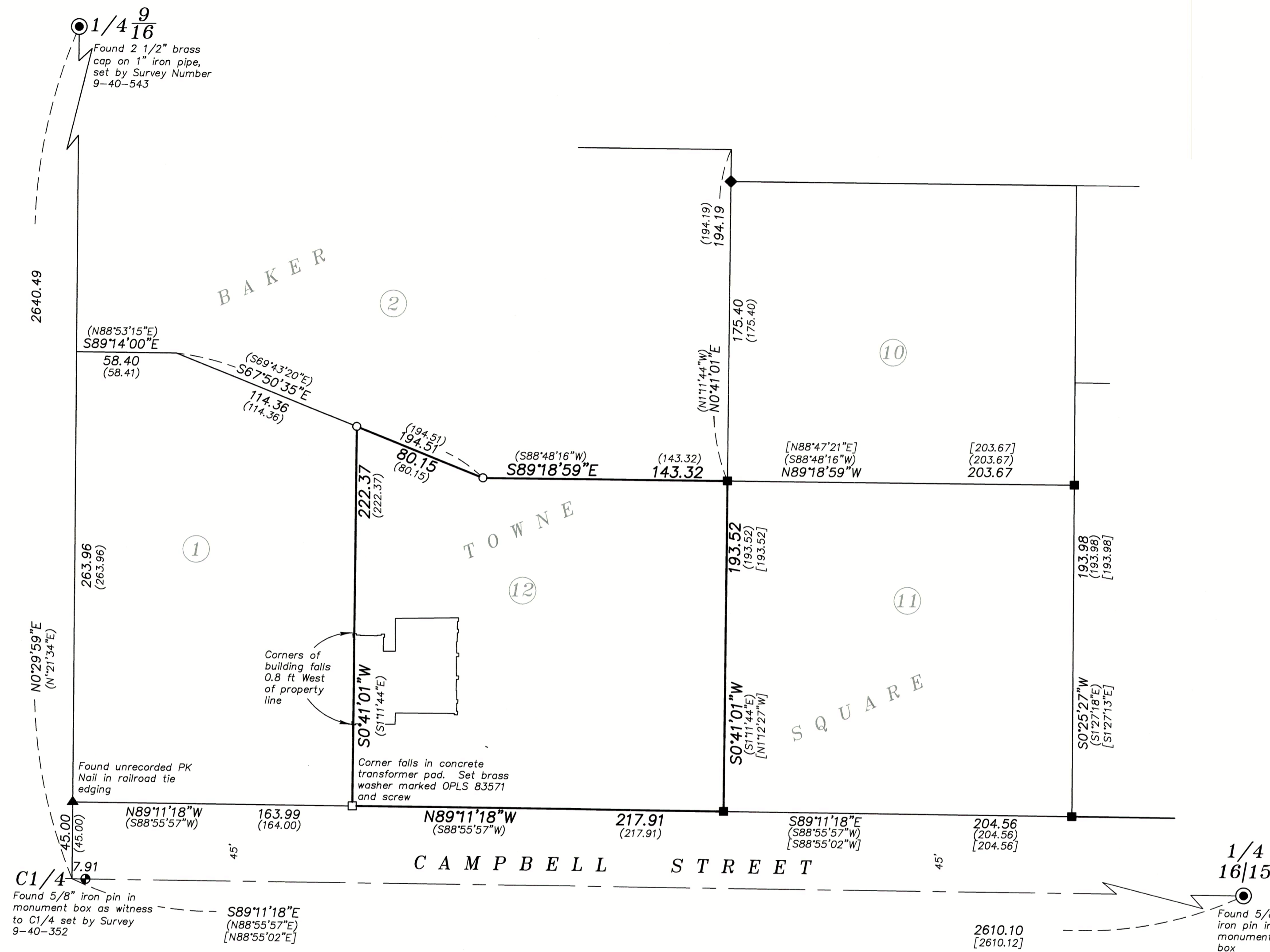

## NARRATIVE

This survey was done at the request of Michael Porter, on behalf of Albertsons. Mr. Porter wanted the exteriors of the property monumented. Lots within this area were originally created by deed, recorded as B02 25 0286 and rerecorded as B02 26 0156, where they are noted as being numbered parcels of Baker Towne Square. They are all metes and bounds descriptions, based on centerlines of Section 16. I rotate the legal descriptions to the East/West running center of section line to place this parcel. It is harmonious with the monuments of Survey 9-40-807 as well as other unrecorded monuments in the area. The corners of the building fall 0.8 ft West of the property line. I find no unusual conditions with this survey.

REGISTERED  
 PROFESSIONAL  
 LAND SURVEYOR

OREGON  
 JUNE 2, 2010  
 JEFFREY S. HSU  
 83571

Renewal Date: June 30, 2023

FILED April 5, 2023  
 BAKER COUNTY SURVEYOR  
 SURVEY NO. 9-40-845

**BAGETT, GRIFFITH & BLACKMAN**  
 2006 Adams Avenue, LaGrande, Oregon  
 Map of Survey

Situated in the Southwest quarter of the Northeast quarter of Section 16 Township 9 South, Range 40 East of the Willamette Meridian, Baker City

BAKER COUNTY	
SURVEYED FOR	Albertsons
SURVEYED BY	J. S. H.
Scale: 1" = 50'	Drawn by: J. S. H. Mar.-Apr 2023