

**BASIS OF BEARINGS**

RECORD SURVEY NO. 9-40-610  
 THE CENTERLINE OF PLACE AVENUE BETWEEN BIRCH STREET  
 AND PLUM STREET BEARS N88°37'54"E AS SHOWN

**LEGEND**

- FOUND 5/8" IRON PIN WITH NO CAP BELOW GROUND IN A CAST IRON CITY MONUMENT CASE
- FOUND 5/8" IRON PIN WITH NO CAP FROM SURVEY NO. 9-40-207
- FOUND 5/8" IRON PIN WITH ATTACHED YELLOW PLASTIC CAP MARKED "HANLEY ENGR. PLS 1206" FROM SURVEY NO. 9-40-207
- FOUND PK NAIL OF UNKNOWN ORIGIN SET IN ASPHALT STREET SURFACE AS ACCEPTED IN SURVEY NO. 9-40-610
- SET 5/8"x30" IRON PIN WITH ATTACHED YELLOW PLASTIC CAP MARKED BENCHMARK SURVEYING
- ( ) RECORD DISTANCE FROM PLAT OF PACIFIC ADDITION
- [ ] RECORD BEARING AND DISTANCE FROM SURVEY NO. 9-40-207
- 1[ ] RECORD BEARING AND DISTANCE FROM SURVEY NO. 9-40-610
- X—X FENCE LINE

**NARRATIVE**

THIS SURVEY WAS PERFORMED AT THE REQUEST OF KENNETH AND SUSAN YEN. THE PURPOSE OF THIS SURVEY WAS TO MONUMENT THE NORTHEAST AND NORTHWEST CORNERS OF THEIR PROPERTY AS DESCRIBED IN DEED NO. B11 49 0195.

A SEARCH WAS MADE OF THE AVAILABLE RECORDS PERTAINING TO THIS SURVEY. FIELD MEASUREMENTS WERE MADE TO LOCATE APPURTENANT MONUMENTS SHOWN ON RECORD SURVEY NO.'S 9-40-207 AND 9-40-610.

I SET NEW MONUMENTS ACCORDING TO THE EVIDENCE FOUND, AND ACCORDING TO THE DEED AND SURVEY RECORD, AS SHOWN HEREON.

**REFERENCES**

- PLAT OF PACIFIC ADDITION TO BAKER CITY
- BAKER CITY ORDINANCE NO.'S 2892 & 2910
- RECORD MAP OF SURVEY NO.'S 9-40-207, 9-40-610 & 693
- DEED RECORD INSTRUMENT NO.'S B11 49 0195, B04 41 0118, B11 48 0051, 84 41 070 AND 88 32 052

REGISTERED  
**PROFESSIONAL  
 LAND SURVEYOR**  
  
**OREGON**  
 NOVEMBER 30, 2007  
**JASON L. HATFIELD**  
 #69454  
 EXPIRES: 6/30/2013

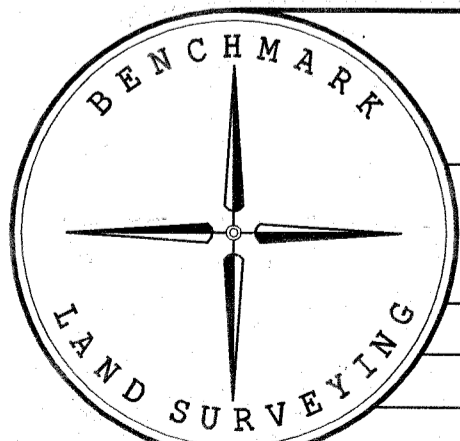

**BENCHMARK LAND SURVEYING**  
 217 N. CANYON BLVD. JOHN DAY, OREGON  
 2101 MAIN STREET, STE 223 BAKER CITY, OREGON  
 541-575-1251 ~ 800-699-0516

<b>MAP OF SURVEY</b> IN BLOCK 39 PACIFIC ADDITION TO BAKER CITY SITUATED IN THE NW1/4NE1/4 SECTION 21, T.9S., R.40E., W.M., CITY OF BAKER CITY, BAKER COUNTY, OREGON		
SURVEYED FOR	<b>KENNETH AND SUSAN YEN</b>	
SURVEYED BY	JLH	1/31/2012
SCALE: 1"=50'	DRAWN BY: JLH	

FILED Feb. 4, 2012  
 BAKER COUNTY SURVEYOR  
 SURVEY NO. 9-40-698