

PARTITION PLAT NO. P2009-005

A PARTITION OF A PARCEL OF LAND IN BLOCK 1 OF THE U.S. TOWNSITE OF BAKER. LOCATED IN THE SE 1/4 OF THE SE 1/4 OF SECTION 17, TOWNSHIP 9 SOUTH, RANGE 40 EAST, WILLAMETTE MERIDIAN, BAKER CITY, BAKER COUNTY, OREGON.

SURVEY FOR SURVEY FOR SURVEY BY

ELKHORN TITLE COMPANY
ATTN: DAN MOORE
1725 MAIN STREET
BAKER CITY, OR 97814
(541) 523-6477

MICHAEL E. WILLIAMS
VALERIE WILLIAMS
1935 VALLEY
BAKER CITY, OR 97814

HANLEY ENGINEERING, INC.
TOM HANLEY, PLS 1817
P.O. BOX 701
BAKER CITY, OR 97814
(541) 523-3803

LEGEND

- SET 5/8" X 30" REBAR WITH YELLOW PLASTIC CAP MARKED "HANLEY ENGR. PLS 1817".
- ⊙ SET 5/8" X 30" REBAR WITH YELLOW PLASTIC CAP MARKED "HANLEY ENGR. PLS 1817" AS REFERENCE MONUMENT, AS NOTED.
- ☐ FOUND STREET CENTERLINE MONUMENT IN MONUMENT BOX AS NOTED.
- < > RECORD AS PER ORIGINAL PLAT OF U.S. TOWNSITE OF BAKER.
- { } RECORD AS PER BAKER TOWER CONDOMINIUM PLAT SD2005-004.
- × CALCULATED POSITION, NO MONUMENT SET.

SURVEYED THROUGH
JULY 31, 2008



SCALE 1"=30'

REFERENCES

ORIGINAL PLAT U.S. TOWNSITE OF BAKER
BAKER COUNTY SURVEY NO. 9-40-137BC
BAKER COUNTY SURVEY NO. 9-40-550
BAKER COUNTY PLAT SD2005-004
BAKER COUNTY DEED NO. 95-25-065
BAKER COUNTY DEED NO. 95-26-013
BAKER COUNTY DEED NO. 97-10-168

SURVEYOR'S CERTIFICATE

I, THOMAS J. HANLEY, A REGISTERED PROFESSIONAL LAND SURVEYOR IN THE STATE OF OREGON, DO HEREBY CERTIFY THAT I HAVE CORRECTLY SURVEYED AND MARKED ON THE GROUND WITH PROPER MONUMENTATION IN ACCORDANCE WITH O.R.S. CHAPTER 92, A PARCEL OF LAND LOCATED IN THE SOUTHEAST 1/4 OF THE SOUTHEAST 1/4 OF SECTION 17, TOWNSHIP 9 SOUTH, RANGE 40 EAST, WILLAMETTE MERIDIAN, MORE PARTICULARLY DESCRIBED AS FOLLOWS:

LAND IN THE UNITED STATES TOWNSITE, BAKER CITY, BAKER COUNTY, OREGON, AS FOLLOWS: IN BLOCK 1: LOTS 6 AND 7.

SAID PARCEL CONTAINING 10,113 SQUARE FEET, MORE OR LESS.

SUBJECT TO A POSSIBLE ENCROACHMENT RECORDED IN DEED NO 95-25-065.

SUBJECT TO ANY EASEMENTS OR RIGHT OF WAYS.

NARRATIVE

WE WERE EMPLOYED BY DAN MOORE TO COMPLETE THE SURVEY REQUIREMENTS OF THIS MINOR PARTITION. SEARCH IN THE FIELD RECOVERED AND HELD EXISTING MONUMENTATION FROM BAKER COUNTY SURVEY NO. 9-40-604SD. PARTITION LINE WAS SURVEYED ACCORDING TO PLANNING DECISION NO. 08-TYPE II-13 AND MONUMENTATION WAS SET FOR THE FOUR CORNERS OF PARCEL 2 OF THIS PARTITION.

SURVEY WAS PERFORMED USING A PENTAX III-10 TOTAL STATION.

I, THOMAS J. HANLEY, HEREBY CERTIFY THAT THIS IS AN EXACT COPY OF THE PLAT AS SUBMITTED TO THE BAKER COUNTY CLERK FOR RECORDING.

APPROVALS

WE, THE UNDERSIGNED OFFICERS IN AND FOR BAKER CITY AND BAKER COUNTY, OREGON, DO HEREBY APPROVE THIS MINOR PARTITION PLAT:

BAKER CITY SURVEYOR BY: Lucy Van Pelt PLS 2162 DATE 10-22-2008

BAKER CITY PLANNING BY: Tracy DATE 10.20.08

I HEREBY CERTIFY THAT ALL TAXES FOR THE SUBJECT PROPERTY HAVE BEEN PAID AS REQUIRED.

BAKER COUNTY TAX COLLECTOR BY: Alice Durlinger DATE 4-17-09

STATE OF OR } S.S. I DO HEREBY CERTIFY THAT THIS MINOR PARTITION PLAT WAS RECEIVED FOR RECORDING ON THE 16th DAY OF April, 2009, AT 8:45 O'CLOCK A.M. AND RECORDED IN BAKER COUNTY RECORDS AND IS HEREBY APPROVED.

BAKER COUNTY CLERK BY: Jamora J. Green, Co. Clerk
by Karen Phillips, Deputy

ACKNOWLEDGMENT

ON Oct. 17, 2008 BEFORE ME DID PERSONALLY APPEAR THE WITHIN NAMED MICHAEL E. WILLIAMS AND VALERIE WILLIAMS WHO ACKNOWLEDGED TO ME THAT THEY EXECUTED THE SAME FREELY AND VOLUNTARILY.

STATE OF Oregon }
COUNTY OF Baker } S.S.

Karin Lequerica
NOTARY PUBLIC
MY COMMISSION EXPIRES June 8, 2009

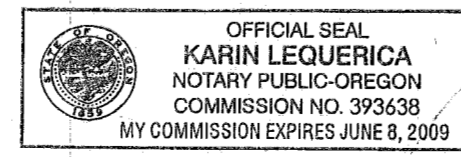

DECLARATION

KNOW ALL PEOPLE BY THESE PRESENTS THAT MICHAEL E. WILLIAMS AND VALERIE WILLIAMS ARE THE OWNERS OF THE LAND REPRESENTED ON THIS PARTITION PLAT, AND MORE PARTICULARLY DESCRIBED IN THE ACCOMPANYING SURVEYOR'S CERTIFICATE AND HAVE CAUSED THE SAME TO BE PARTITIONED INTO TWO PARCELS AS SHOWN, IN ACCORDANCE WITH O.R.S. CHAPTER 92.

Michael E. Williams
MICHAEL E. WILLIAMS
Valerie Williams
VALERIE WILLIAMS

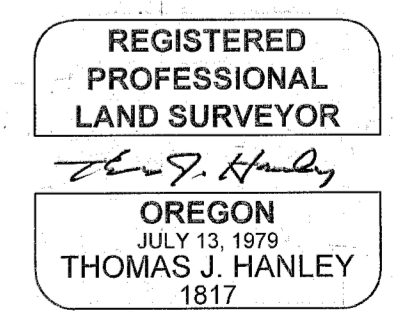

Renews June 30, 2009

SHEET 1 OF 1

FILED April 16, 2009
BAKER COUNTY SURVEYOR
SURVEY NO. 9-40-667MP

FOUND BRASS CAP
IN MON. BOX

BASIS OF BEARING
BAKER COUNTY PLAT SD2005-004, AUBURN
AVENUE BETWEEN FIRST STREET AND MAIN
STREET BEARS N89°47'01"E

FIRST STREET

VALLEY AVENUE

<306.5'>
{S89°46'05"W, 306.73'}
S89°46'05"W, 306.73'

FOUND 5/8" REBAR WITH
YELLOW PLASTIC CAP
MARKED "CITY OF
BAKER PLS 2162"

MAIN STREET

<292.5'>
{S00°36'19"W, 292.61'}
S00°36'19"W, 292.61'

ALLEY

<292.5'>
{S00°38'47"W, 292.69'}
S00°36'19"W, 292.61'

252.68'

40'

AUBURN AVENUE

100.01'
<100'>

N89°47'01"E, 306.52'
{N89°47'01"E, 306.52'}, BASIS OF BEARING
<306.5'>

100.01'
<100'>

FOUND 5/8" REBAR WITH
YELLOW PLASTIC CAP
MARKED "CITY OF
BAKER PLS 2162"

