

B05 19 0331

REGISTERED
PROFESSIONAL
LAND SURVEYOR

Danny K. Cummings

OREGON
JAN. 21, 1988
DANNY K. CUMMINGS
2316

RENEWAL DATE: 12-31-05

0 10 20

SCALE 1" = 10'

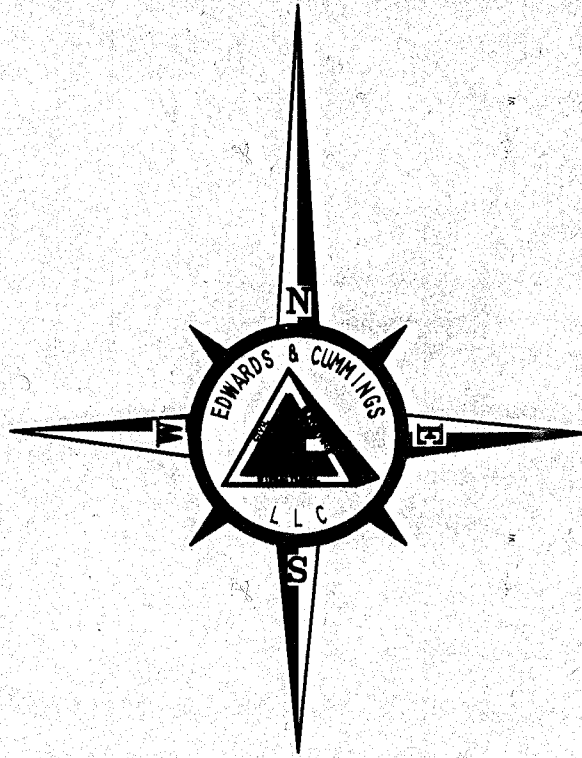

Danny K. Cummings HEREBY CERTIFY THAT
THIS IS AN EXACT REPRODUCTION OF THE ORIGINAL.

Danny K. Cummings

B05 19 0332
SD2005-004

BAKER TOWER CONDOMINIUM
a Replat of Lot 2, a portion of Lots 1 and 3,
in Block 1 of the U.S. Townsite of Baker, and
Lot 6, and a portion of Lot 7, in Block D,
of M.E. Place's Addition,
within the SE1/4SE1/4 Section 17, and
within the NE1/4NE1/4 Section 20, T9S, R40E, W.M.,
Baker City, Baker County, Oregon

B05 19 0333

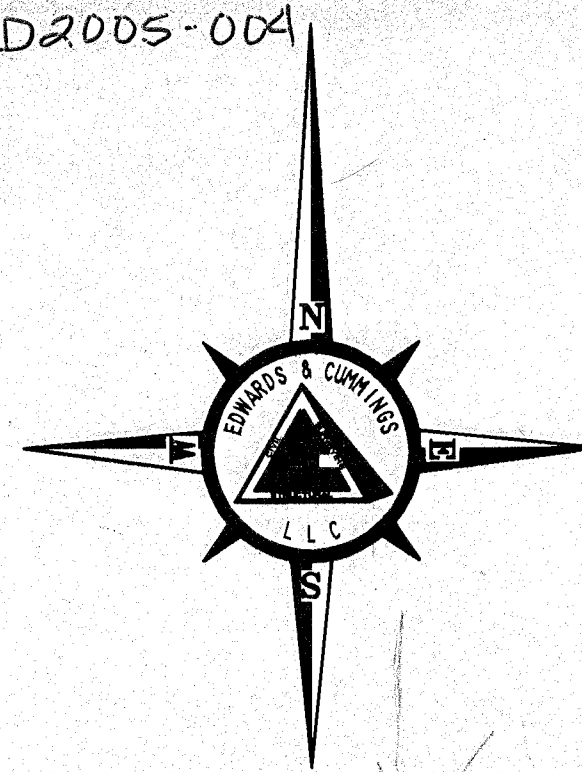

EXTERIOR BUILDING
FOOTPRINT

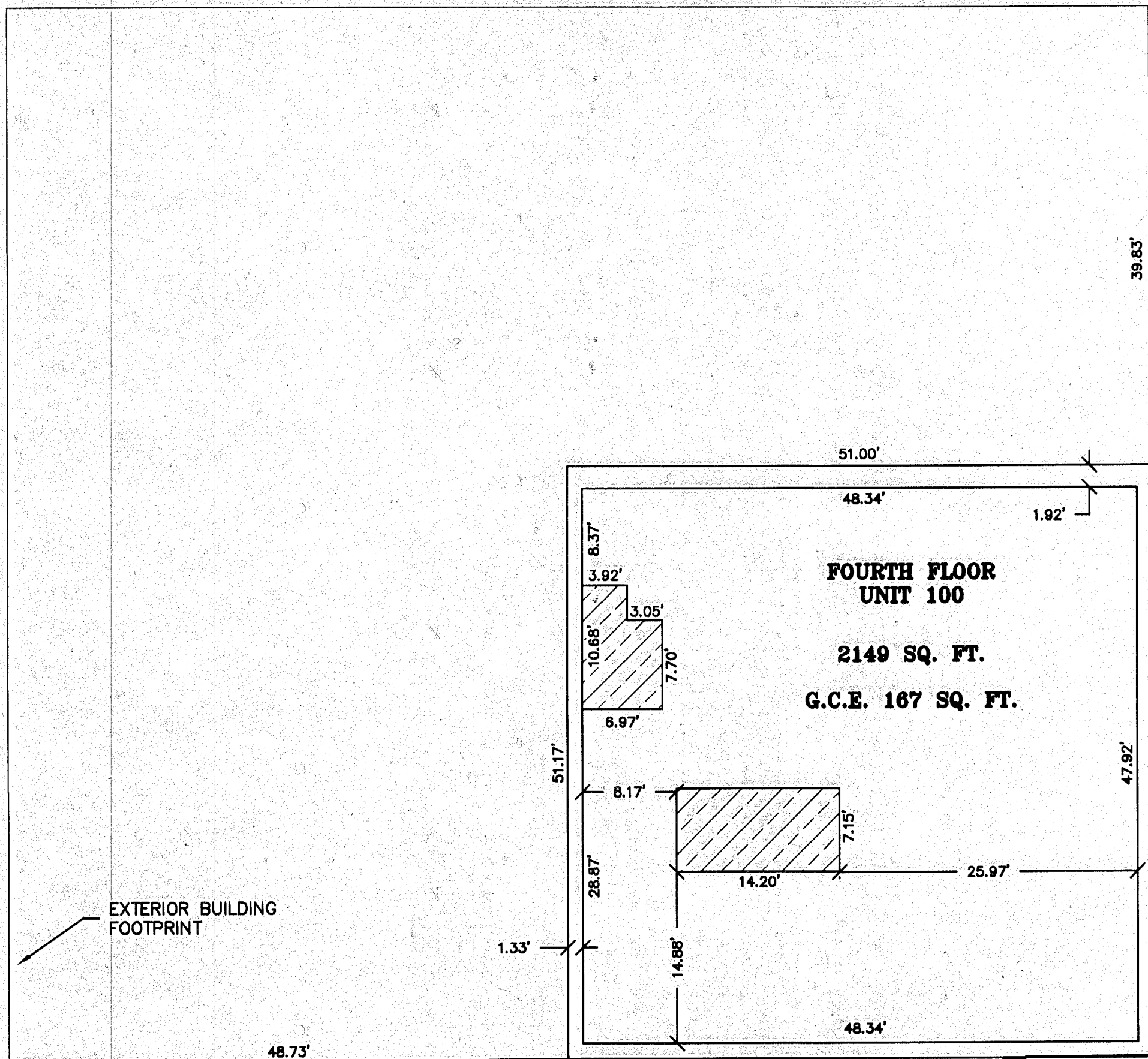

EXTERIOR BUILDING
FOOTPRINT

FOURTH FLOOR

LEGEND

GENERAL COMMON ELEMENT (G.C.E.)

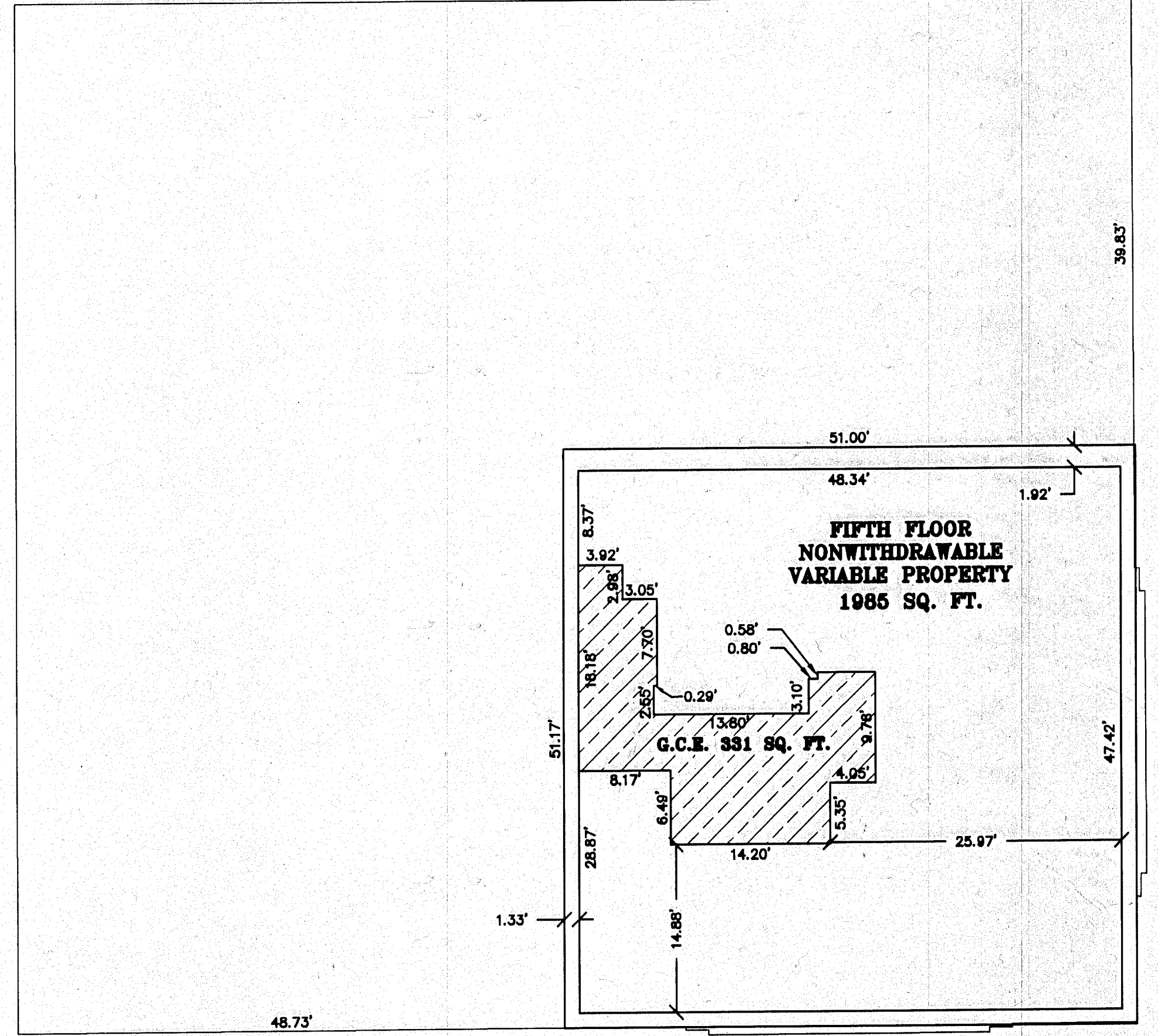
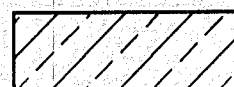

EXTERIOR BUILDING
FOOTPRINT

FIFTH FLOOR

LEGEND

GENERAL COMMON ELEMENT (G.C.E.)



FILED MAY 12, 2005
BAKER COUNTY SURVEYOR
SURVEY NO. 9-40-60450

PAGE 6 OF 10

B-12