

Alpha-Num.  
Index # J-11

**CERTIFIED RECORD OF LAND CORNER MONUMENTATION**

**DIAGRAM**

**History of original corner establishment:**

The original corner was set by Thompson & Chaplin, Deputy Surveyors, under Contract No. 104, dated April 16, 1864.

The original notes state:  
Set post for 1/4 Sec. corner in mound of Earth with charred stake, pits, and trench as per instructions.

Baker County Survey No. 9-40-25BC (City Survey of 1970) established a 5/8" rebar for subject corner. Survey No. 9-40-25BC states, "N1/4 cor. reestablished in position shown on City Engr. plat (about 1920) using plat distances from C1/4 corner and NW Sec. corner."

**Description of corner evidence found:**

Found a 1/2" rebar with yellow plastic cap. Rebar was badly bent. It is assumed that Baker County Survey No. 9-40-25BC was in error by stating this as being a 5/8" rebar.

**Description of monument and accessories I established to perpetuate the original location of the corner:**

The corner was reestablished at the position of the base of the 1/2" rebar. Set a 2 1/2" diameter brass cap on a 1" x 30" galvanized pipe, guarded by a steel fence post. The cap is marked as shown in the corner diagram.

No corner monument references were set.

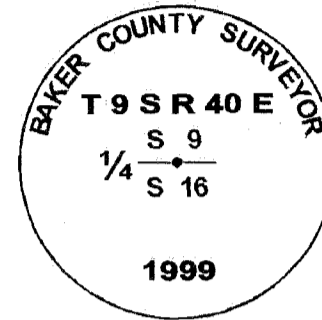

I, Thomas J. Hanley certify that this corner was properly reestablished as witnessed by Eric Stricker and Kirby Danford on November 4, 1998. Monument was stamped on January 6, 1999.

FILED December 31, 2001  
BAKER COUNTY SURVEYOR  
SURVEY NO. 9-40-543  
CORNER PRES. NO. CP #77

**REGISTERED  
PROFESSIONAL  
LAND SURVEYOR**

*Thomas J. Hanley*

**OREGON**  
JULY 13, 1979  
**THOMAS J. HANLEY**  
1817

Renews June 30, 2003