

NARRATIVE

The purpose of this survey for Western Bank, ordered by Dean Guyer, is to mark on the ground with proper monumentation the corners of the subject property.

Intersection monuments at the corners of Main Street and Baker and Main and Church were recovered. Other property monumentation was also recovered the NE corner pin and SE corner pin which were set by Baker County Survey No. 9-40-302 and the SW corner pin which was set by Baker County Survey No. 9-40-288.

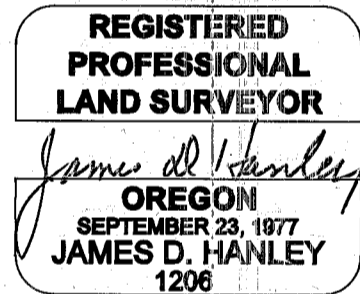

Renews June 30, 1999

LEGEND

- Set 5/8" rebar with plastic cap marked "HANLEY ENGRG. PLS 1206".
- Found, 5/8" rebar with plastic cap marked "HANLEY ENGRG. PLS 1206" set by Baker Co. Survey No. 9-40-302.
- Found 5/8" rebar mkd. "CITY OF BAKER CITY PLS 2162" in steel case.
- Found, monument as noted.
- () Plat distance.
- [] Co. Sur. 9-40-302, brng. & dist.

REFERENCES

- Baker County Survey No. 9-40-288
- Baker County Survey No. 9-40-302

MAP OF SURVEY ALL BLOCK 2, LESS THE WEST 100 FEET, BOYD'S ADDITION TO BAKER CITY, OREGON

Surveyed September 28, 1998

for Western Bank

Scale: 1" = 100'

HANLEY ENGINEERING
2043 MAIN STREET
BAKER CITY, OREGON

FILED Nov. 2, 1998
BAKER COUNTY SURVEYOR
SURVEY NO. 9-40-488