

NARRATIVE

This survey for Chris Dunn is for purpose of marking certain corners of his property on the ground with proper monumentation, surveying two irrigation ditches and Powder River through the subject property and depicting on this map of survey. Control monumentation consisting of record street intersection was recovered as basis of the proportioned block distances. Reference for this subject survey is County Survey No. 9-40-238, Mix's Addition Plat, Baker City coordinate sheet of city monuments.

LEGEND

- - SET 5/8" x 30" REBAR W/ YELLOW PLASTIC CAP MARKED "HANLEY ENGRG PLS 1206."
- ⊠ - FOUND MONUMENT IN BOX AS NOTED
- () MIX ADD'N PLAT DISTANCE

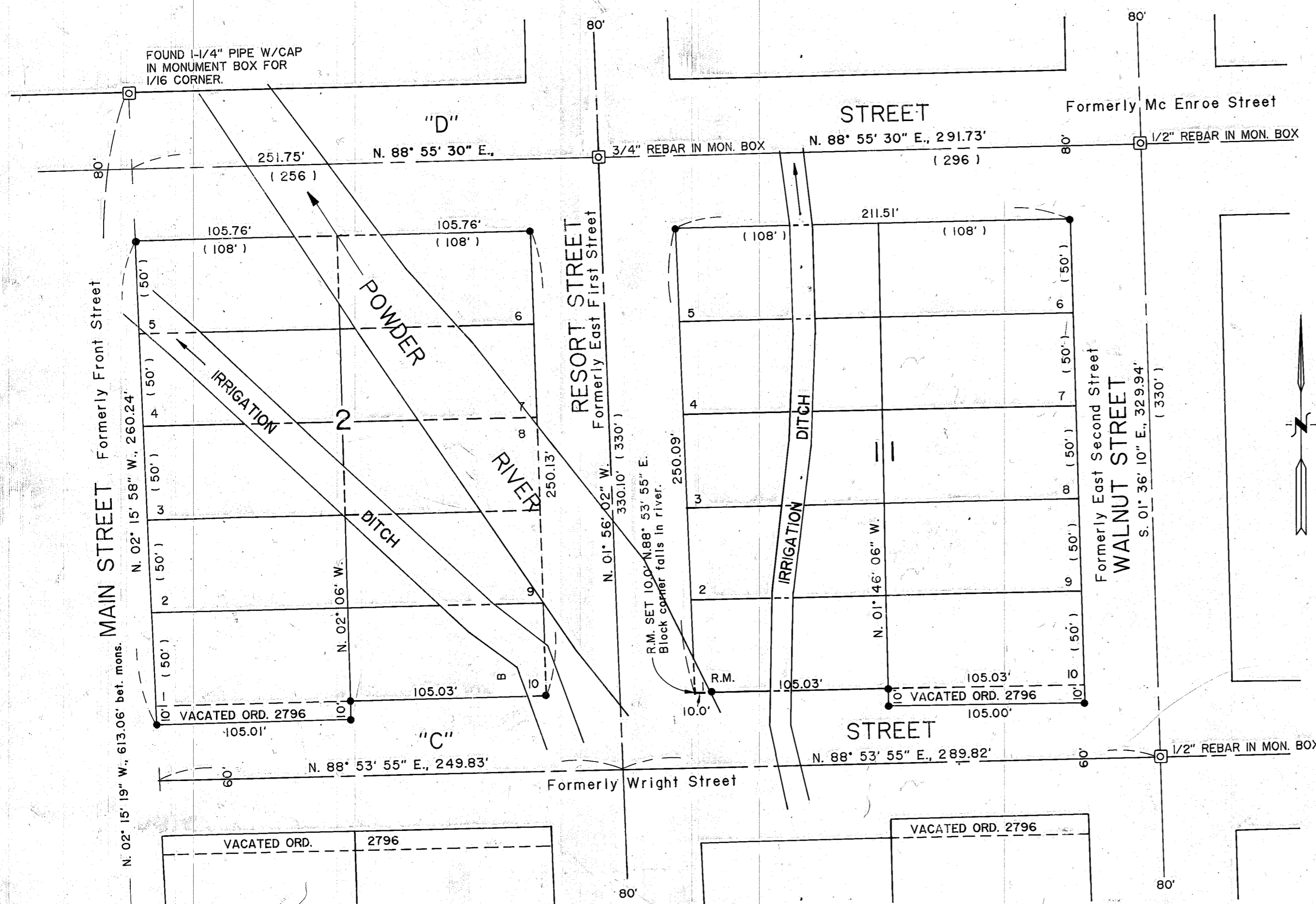

MAP OF SURVEY

IN BLOCK 2 AND II, MIX'S ADDITION
 BAKER CITY, OREGON
 Surveyed for Chris Dunn
 April 25 and July 16, 1996
 SCALE: 1" = 50'

HANLEY ENGINEERING
 BAKER CITY, OREGON

REGISTERED
 PROFESSIONAL
 LAND SURVEYOR
James D. Hanley
 OREGON
 SEPTEMBER 21, 1991
 JAMES D. HANLEY
 1206

Renews June 30, 1997

FILED 7-31-96
 BAKER COUNTY SURVEYOR
 SURVEY NO. 9-40-439