

Scale: feet
 0 5 10 20 30
 1 inch equals 16 feet

LEGEND
 ——— INTERIOR UNIT BOUNDARY
 G.C.E. GENERAL COMMON ELEMENT
 L.C.E. LIMITED COMMON ELEMENT

BASEMENT

PARKING ASSIGNMENTS

UNIT NO.	PARKING SPACE	UNIT NO.	PARKING SPACE
B-1	26	101	24
B-2	27	102	25
B-3	2	103	22
B-4	3	104	23
		105	9
		106	10
		107	4
		108	1

Basis of elevations: U.S.C.G.S. Benchmark No. V483, set in 1941 at the North entrance to the Baker Junior High School. Elevation of Benchmark is 3440.04 feet.

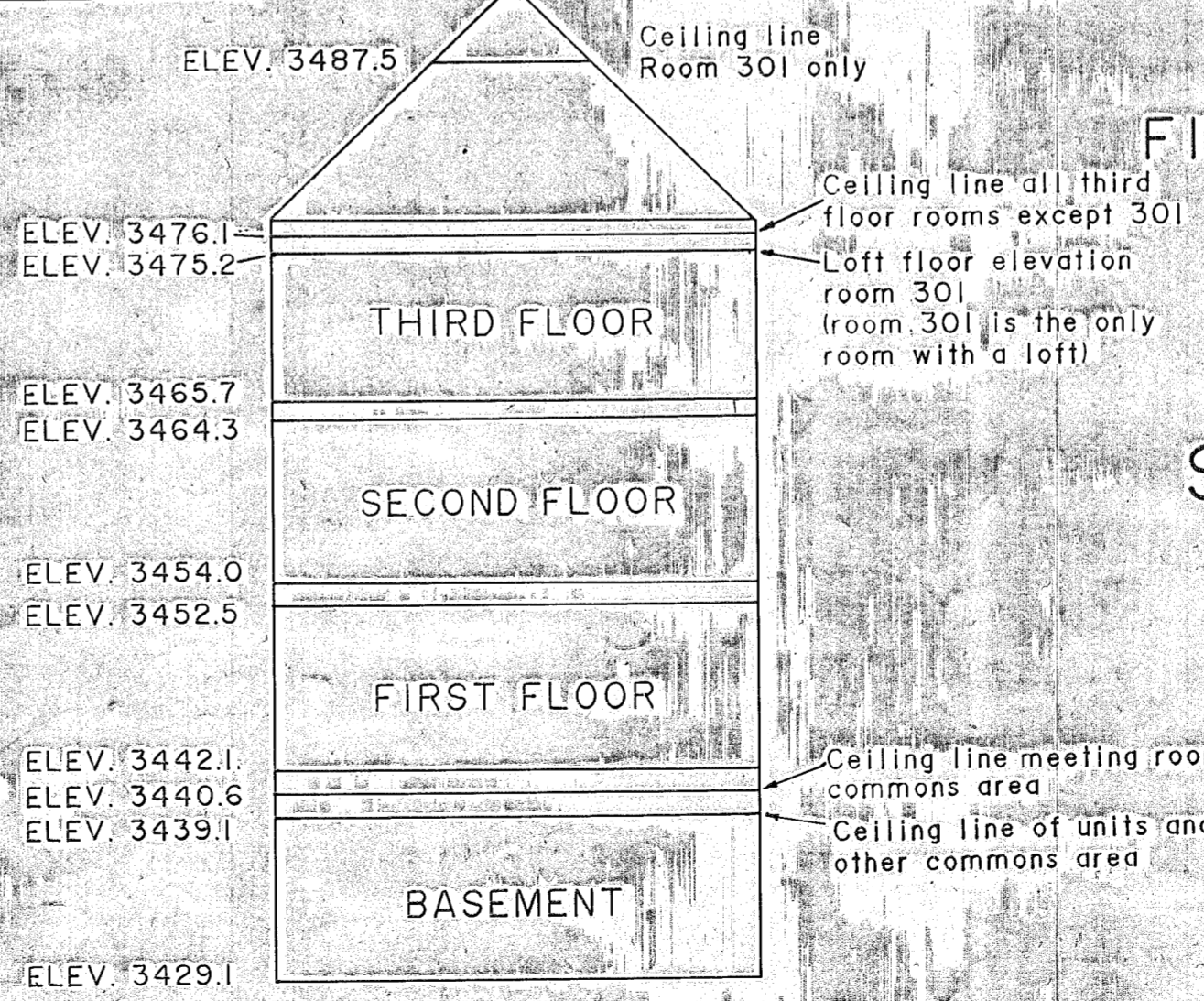

FIRST FLOOR

Ceiling line Room 301 only
 Ceiling line all third floor rooms except 301
 Loft floor elevation room 301 (room 301 is the only room with a loft)

ST. ELIZABETH TOWERS CONDOMINIUM

REGISTERED PROFESSIONAL LAND SURVEYOR

James D. Hanley

OREGON
 SEPTEMBER
 JAMES D. HANLEY
 1206

No Scale