

"H" STREET N. 89° 07' 24" E., 296.49'

ELM STREET N. 01° 40' 24" W., 331.65'

GROVE STREET N. 01° 28' 05" W., 331.37'

Meridian based on City Survey, 1970-'71

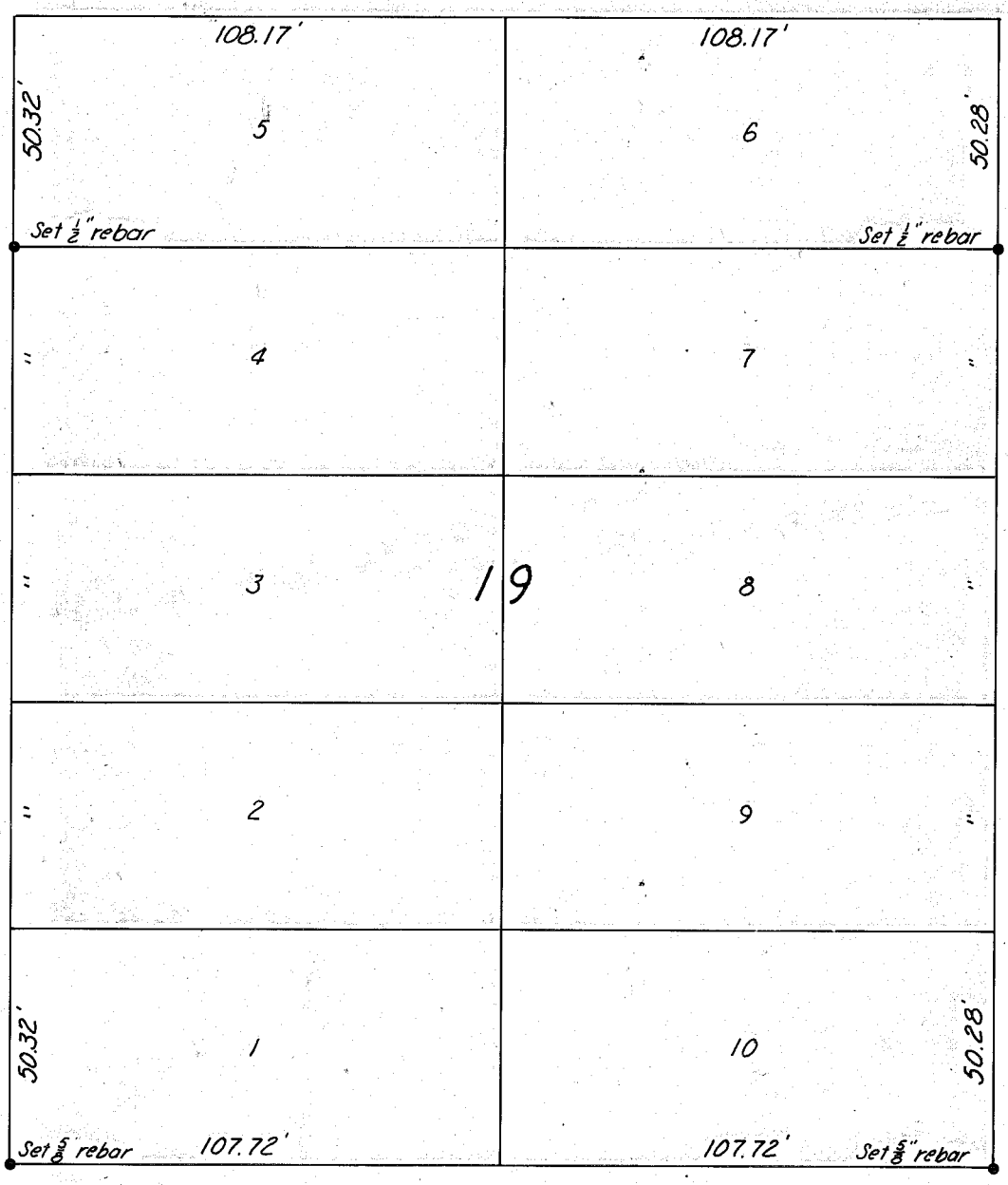

"G" STREET N. 89° 04' 17" E., 295.30'

MAP OF SURVEY

LOTS 1-4 & 6-10, BLOCK 19, MIX ADD'N TO BAKER, OREGON

December 30, 1976 Scale 1"=40'

For Aaron Densley

FILED Jan. 2, 1977

BAKER COUNTY SURVEYOR

SURVEY NO. 9-40-91 BC

