

CERTIFIED RECORD OF LAND CORNER MONUMENTATION

1 of 2

History of original corner establishment:

Corner established by Wm. W. Elmer, U.S. Deputy Mineral Surveyor, under instructions received from the United States Surveyor General for Oregon dated Oct. 23, 1906, and designated as Survey No. 679

Surveyor General records state:

A pine post 4 ft long 6 ins square set 1 1/2 ft in the ground with mound of earth and stone, scribed 2-679-K.

A tamarack 10 ins dia bears S33°05'W 21.90 ft, a tamarack 10 ins dia bears N88°20'E 19.04 ft, both blazed and scribed 2-679-K BT.

Corner was remonumented by: William L. Hanley, per Corner Record 9-37-101; dated March 14, 1986.

Found remains of original pine post.

A tamarack stump with full scribes sawed off above scribes brs S33°W, 21.9 ft.
A tamarack 14 ins dia with full scribes on an open blaze brs N88°20E, 19.04 ft

Set a 2 1/2" aluminum cap on 2" aluminum pipe 30 ins long 25 ins in ground with 5 ins proj. out of ground with surrounding rock mound and 6 ft steel fence post alongside with sign 54-9 attached. Buried remains of original post alongside.

Aluminum cap marked as shown in corner diagram.

New bearing tree established:

A pine 6 ins dia bears N15°E 24.6 ft marked K-2-679 BT.

Each original bearing tree and each new bearing tree has signs 54-3 and 54-9 attached below a 6 inch band of red paint, additionally each new bearing tree has a brass washer marked PLS 1639 nailed flush with BT blaze.

I hereby certify that the above described corner monument was properly established by me and witnessed by Jim DeMastus and Daryl Schuchardt on April 30, 1985.

T 9 S R 37 E
MS 679
2 K

**Katherine
Cor. 2**

Continued on page 2 of 2

REGISTERED
PROFESSIONAL
LAND SURVEYOR

OREGON
MAY 9, 2017
KRISTINA POWELL
91201

EXPIRES 12-31-24

FILED January 3, 2024
BAKER COUNTY SURVEYOR
SURVEY NO. 9-37-388

CERTIFIED RECORD OF LAND CORNER MONUMENTATION

Description of corner evidence found:

A 2 inch aluminum pipe with a 2 1/2 inch aluminum cap, marked as shown. Firmly set 6 inches above ground, with a rock collar.

From which:

A 14 inch tamarack (by Elmer) with open blaze and visible scribe marks, bears N88°20'E, 19.04 feet, alive with dead top.

An 8 inch tamarack high stump (by Elmer) with open blaze and visible scribe marks, bears S33°W, 21.9 feet.

An 8 inch pine snag (by Hanley) with partially healed blaze and visible scribe marks, bears N15°E, 24.6 feet.

Monument falls East 270 feet from Cracker Creek Road, on the East side of Cracker Creek.

2 of 2

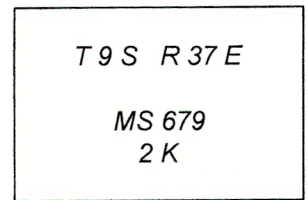

**Katherine
Cor. 2**

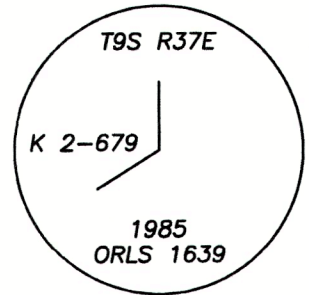

Description of monument and accessories I established to perpetuate original location of this corner:

New Bearing Tree:

An 8 inch white fir scribed "X BT" on single blaze, bears S9°E, 21.8 feet; measured to a 3/4 inch brass washer mkd: "LS 91201", at the right side of tree center.

Set a steel T-post S59°W, 5.0 feet; with sign: Property Boundary

Set a steel T-post N7°W, 5.0 feet; with two (2) signs: Property Boundary, Land Survey Monument

Added Bearing Tree and Land Survey Monument signs as needed.

NAD 83 Geodetic Position

Lat. 44°47'47.3" N
Long. 118°11'51.6" W

Established by: Garmin ETREX 32x

I hereby certify that the corner is monumented and accessories taken as described using a steel tape and a Warren Knight staff compass, set with a declination of 14° East.

Witnesses: David Quittschreiber, Justin Seal

August 29, 2023

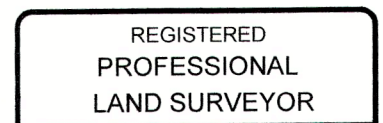

Kristina Powell



EXPIRES 12-31-24

FILED January 3, 2024
BAKER COUNTY SURVEYOR
SURVEY NO. 9-37-388