

CERTIFIED RECORD OF LAND CORNER MONUMENTATION

History of original corner establishment:

Corner established BY Wm. W. Elmer, U.S. Deputy Mineral Surveyor, under instructions received from the United States Surveyor General for Oregon dated Oct. 23, 1906, and designated as Survey No. 679.

Surveyor General records state:

A pine post 2 1/2 ft long 5 ins square set on bedrock with mound of earth and stone, scribed 3-679-FC.

A fir 8 ins dia bears S01°27'W 27.40 ft, a fir 8 ins dia bears S54°20'W 67.55 ft. both blazed and scribed 3-679-FC BT.

Corner was remonumented by: William L. Hanley, per Corner Record 9-37-99; dated March 14, 1986.

No trace of original pine post.

No trace of original bearing trees.

Set a 3 inch brass rock cap with concrete and rebar anchor.

New bearing trees established:

A fir 14 ins dia bears N41 1/2°W 39.5 ft marked 3-FC-679 BT.

A fir 10 ins dia bears S08 1/2°W 65.3 ft marked 3-FC-679 BT.

Each new bearing tree has signs 54-3 and 54-9 attached below a 6 inch band of red paint and a brass washer marked PLS 1639 nailed flush with BT blaze.

I hereby certify that the above described corner monument was properly established by me and witnessed by Jim DeMastus on May 20, 1985.

Continued on page 2 of 2

T 9 S R 37 E
MS 679
3 FC

First Chance
Cor. 3

REGISTERED
PROFESSIONAL
LAND SURVEYOR

Kristina Powell

OREGON
MAY 9, 2017
KRISTINA POWELL
91201

EXPIRES 12-31-24

FILED January 3, 2024
BAKER COUNTY SURVEYOR
SURVEY NO. 9-37-387

CERTIFIED RECORD OF LAND CORNER MONUMENTATION

Description of corner evidence found:

A 3 inch brass rock cap, set in concrete at ground level.

From which:

A 12 inch fir snag (by Hanley) with healed blaze, bears S8 1/2°W, 65.3 feet.

A 14 inch fir snag (by Hanley) dead and down, with visible scribing, bears N41 1/2°W, 39.5 feet to stump hole.

A steel T-post bears S40 1/2°E, 45.0 feet; with two (2) signs: Property Boundary, Land Survey Monument.

A steel T-post bears N55°E, 50.0 feet; with sign: Property Boundary.

Corner falls in rock bluff East of Cracker Creek, and East 260 feet from Cracker Creek Road.

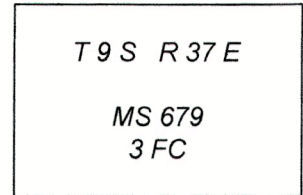

First Chance
Cor. 3

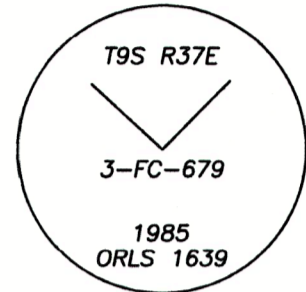

Description of monument and accessories I established to perpetuate original location of this corner:

New Bearing Trees:

An 11 inch ponderosa pine scribed "3 FC 679 BT" bears S55°E, 17.9 feet; measured to a 3/4 inch brass washer mkd: "LS 91201", at the right side of tree center.

A 12 inch ponderosa pine scribed "3 FC 679 BT" bears S16°W, 53.6 feet; measured to a 3/4 inch brass washer mkd: "LS 91201", at the right side of tree center.

Added Bearing Tree and Land Survey Monument signs as needed.

NAD 83 Geodetic Position

Lat. 44°47'48.7" N
Long. 118°11'51.2" W

Established by: Garmin ETREX 32x

I hereby certify that the corner is monumented and accessories taken as described using a steel tape and a Warren Knight staff compass, set with a declination of 14° East.

Witnesses: David Quittschreiber, Justin Seal

August 29, 2023

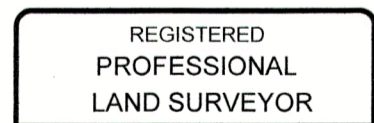

Kristina Powell

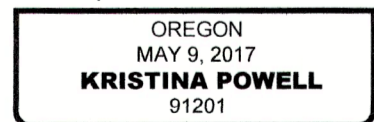

EXPIRES 12-31-24

FILED January 3, 2024
BAKER COUNTY SURVEYOR
SURVEY NO. 9-37-387