

CERTIFIED RECORD OF LAND CORNER MONUMENTATION

1 of 2

History of original corner establishment:

Corner established by John Hagel, U.S. Deputy Surveyor, under instructions received from United States Surveyor General for Oregon, dated April 7, 1902, and designated as Survey No. 470.

Surveyor General records state:

Set a yellow pine post 4 ins square 4 1/2 ft long 18 ins in ground scribed BRB N CEN470 with a mound of rocks around it.
A yellow pine 12 ins dia blazed and scribed BRB N CEN S 470 BT bears S80°05'W 17.3 ft.

Corner position remonumented by: John R. Mitchell in 1980 ... Set 2 1/2 ins brass cap on a 32" x 1" galv pipe in rock mound marked BRNECMS470.
A white fir 8 ins dia bears S10°W 19 ft marked BRNECMS470 BT.

Corner was remonumented by: William L. Hanley, per Corner Report 9-37-128; dated March 14, 1986.

Found monument set by John R. Mitchell.

A ponderosa pine 20 ins dia bears S80°W 17.3 ft.

Tree found set by John R. Mitchell:
A white fir 8 ins dia bears S10°W 19 ft.

Set a 2 1/2" aluminum cap on 2" aluminum pipe 30 ins long 25 ins in ground with 5 ins proj. out of ground with surrounding rock mound and 6 ft steel fence post alongside with sign 54-9 attached. Monument buried alongside north.

Aluminum cap marked as shown in corner diagram.

Each original bearing tree has signs 54-3 and 54-9 attached below a 6 inch band of red paint.

I hereby certify that the above described corner monument was properly established by me and witnessed by Jim DeMastus and Daryl Schuchardt on May 8, 1985.

Continued on page 2 of 2

T 9 S R 37 E
MS 470
NEC BRB

**Brown Bear
Corner,
North End Center**

REGISTERED
PROFESSIONAL
LAND SURVEYOR

Kristina Powell

OREGON
MAY 9, 2017
KRISTINA POWELL
91201

EXPIRES 12-31-24

FILED January 3, 2024
BAKER COUNTY SURVEYOR
SURVEY NO. 9-37-370

CERTIFIED RECORD OF LAND CORNER MONUMENTATION

Description of corner evidence found:

A 2 inch aluminum pipe with a 2 1/2 inch aluminum cap, marked as shown. Firmly set 5 inches above ground, with rock collar.

From which:

A 24 inch ponderosa pine (by Hagel) with healed blaze, bears S80°W, 17.3 feet, alive and healthy.

BT (by Mitchell), not found.

A steel T-post bears N80°W, 5.0 feet; with two (2) signs: Property Boundary, Land Survey Monument

Monument falls East 0.25 miles from Cracker Creek Road; and East 525 feet from a 10-foot wide dirt road, slightly overgrown.



**Brown Bear
Corner,
North End Center**

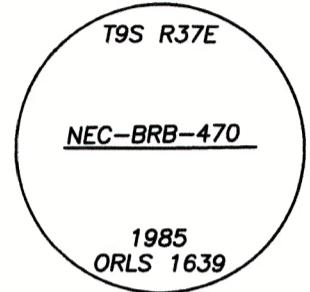

Description of monument and accessories I established to perpetuate original location of this corner:

New bearing Tree:

A 7 inch white fir scribed "NEC BRB 470 BT" bears S1°W, 15.5 feet; measured to a 3/4 inch brass washer mkd: "LS 91201", at the right side of tree center.

Set a steel T-post S77 1/2°E, 5.0 feet; with sign: Property Boundary.

Added Bearing Tree and Land Survey Monument signs as needed.

NAD 83 Geodetic Position

Lat. 44°48'52.5" N
Long. 118°12'10.2" W

Established by: Garmin ETREX 32x

I hereby certify that the corner is monumented and accessories taken as described using a steel tape and a Warren Knight staff compass, set with a declination of 14° East.

Witnesses: David Quittschreiber, Justin Seal

August 18, 2023

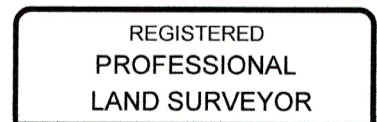

Kristina Powell



EXPIRES 12-31-24

FILED January 3, 2024
BAKER COUNTY SURVEYOR
SURVEY NO. 9-37-37D