

CERTIFIED RECORD OF LAND CORNER MONUMENTATION

History of original corner establishment:

Corner established by Arthur Philbrick, U.S. Deputy Mineral Surveyor, under instructions received from the United States Surveyor General for Oregon, dated Nov. 04, 1901 and designated as Survey No 452.

Surveyor General record state:

A pine post 4 1/2 ft long 4 ins square set 2 ft in the ground with mound of earth, scribed BB 6-452 on NE face whence a tamarack 20 ins in dia bears S87°30'W 19.1 ft and a red fir 24 ins in diam bears S9°30'E 7 ft each blazed and scribed BT BB 6-452

Corner was remonumented by: William L. Hanley, per Corner Record 9-37-113; dated March 14, 1986

Found location post a 10 in dia dead tree blazed on four sides

A green fir 34 ins dia marked "6-452" visible in a partially healed blaze, brs S9°30'E 7 ft. A down tamarack 16 ins dia with full scribes visible, brs S87°30'W 19.1 ft dist.

Set 2 1/2 in aluminum cap on 2 in aluminum pipe 30 ins long 25 ins in ground with 5 ins proj. out of ground with rock mound and 6 ft steel fence post alongside with sign 54-9 attached. Buried remains of original post alongside.

Aluminum cap marked as shown in corner diagram.

New bearing tree established:

A fir 16 ins dia bears N80°30'E 42.5 ft marked BB6-452 BT.

Each original bearing tree and each new bearing tree has signs 54-3 and 54-9 attached below a 6 in band of red paint, additionally each new bearing tree has a brass washer marked PLS 1639 nailed flush with BT blaze.

I hereby certify that the above described corner monument was properly established by me and witnessed by Jim DeMastus on April 23, 1985.

Continued on page 2 of 2

T 9 S R 37 E
MS 452
6 BB

**Black Belle
Quartz Claim
Cor. 6**

REGISTERED
PROFESSIONAL
LAND SURVEYOR

Kristina Powell

OREGON
MAY 9, 2017
KRISTINA POWELL
91201

EXPIRES 12-31-24

FILED January 3, 2024
BAKER COUNTY SURVEYOR
SURVEY NO. 9-37-364

CERTIFIED RECORD OF LAND CORNER MONUMENTATION

Description of corner evidence found:

A 2 inch aluminum pipe with a 2 1/2 inch aluminum cap, marked as shown.

From which:

A 34 inch high fir stump (by Philbrick) with open blaze and visible scribing, bears S9 1/2°E, 7.0 feet.

Rotten tamarack remains (by Philbrick) bear S87 1/2°W, 19.1 feet.

A 22 inch fir snag (by Hanley) with partially healed blaze and visible scribing, bears N 80 1/2°E, 42.5 feet.

A steel T-post bears N19°W, 5.0 feet; with two (2) signs: Property Boundary, Land Survey Monument.

A steel T-post bears N62°E, 35.0 feet; with sign: Property Boundary.

Monument falls West 700 feet of a 10-foot wide gravel road.

Description of monument and accessories I established to perpetuate original location of this corner:

New Bearing Trees:

An 8 inch lodgepole pine scribed "6 BB 452 BT" bears East, 23.7 feet; measured to a 3/4 inch brass washer mkd: "LS 91201", at the right side of tree center.

An 8 inch ponderosa pine scribed "X BT" on single blaze, bears S5°W, 63.3 feet; measured to a 3/4 inch brass washer mkd: "LS 91201", at the right side of tree center.

Added Bearing Tree and Land Survey Monument signs as needed.

NAD 83 Geodetic Position

Lat. 44°47'38.5" N
Long. 118°12'29.8" W

Established by: Garmin ETREX 32x

I hereby certify that the corner is monumented and accessories taken as described using a steel tape and a Warren Knight staff compass, set with a declination of 14° East.

Witnesses: David Quittschreiber, Justin Seal

September 7, 2023

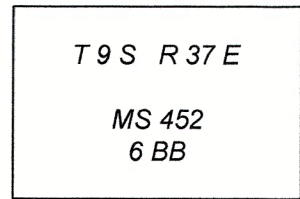

Black Belle
Quartz Claim
Cor. 6

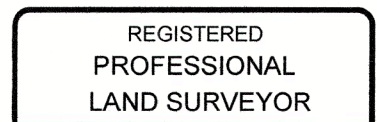
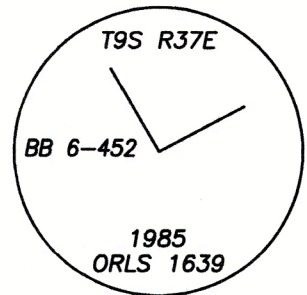

Kristina Powell

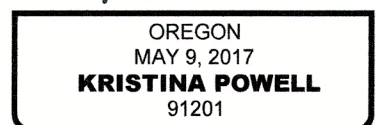

EXPIRES 12-31-24

FILED January 3, 2024
BAKER COUNTY SURVEYOR
SURVEY NO. 9-37-364