

BASIS OF BEARINGS

WOODWELL BASELINE BEARS N.08°16'00"E. AS SHOWN

LEGEND

- FOUND 3" BRASS DISC MARKED "OREGON STATE HIGHWAY DIVISION", SET IN CONCRETE BELOW THE ROAD SURFACE IN AN IRON MONUMENT CASE
- FOUND 1/2" I.D. IRON PIPE OF UNKNOWN ORIGIN
- FOUND 5/8" IRON PIN WITH ATTACHED YELLOW PLASTIC CAP MARKED "PLS 699" FROM RECORD SURVEY NO. 9-37-285
- SET 5/8"x30" IRON PIN WITH ATTACHED YELLOW PLASTIC CAP MARKED "BENCHMARK SURVEYING"
- () DEED/PLAT RECORD DIMENSION
- [] RECORD BEARING AND DISTANCE FROM SURVEY NO. 9-37-285
- x-x CHAIN LINK FENCE

NARRATIVE

THIS SURVEY WAS PERFORMED AT THE REQUEST OF BRUCE WARD, WITH THE PURPOSE OF MONUMENTING LOT 18 IN BLOCK 11 OF SUMPTER HEIGHTS McEWEN'S ADDITION IN THE CITY OF SUMPTER.

SUMPTER HEIGHTS McEWEN'S ADDITION WAS SURVEYED AND PLATTED BY ARTHUR PHILBRICK, CE, IN 1897. THERE IS NO INDICATION THAT ANY PERMANENT MONUMENTATION WAS SET AT ANY OF THE LOT OR BLOCK CORNERS. A SEARCH OF THE BAKER COUNTY SURVEYOR'S RECORDS PRODUCED SURVEY NO.'S 9-37-28 AND 9-37-285. I FOUND THREE OF THE MONUMENTS FROM SURVEY NO. 9-37-285 ALL IN GOOD CONDITION. THESE MONUMENTS, ALONG WITH THE TWO BRASS DISCS IN MILL STREET MARKING THE WOODWELL BASELINE PROVIDED THE CONTROL FOR BLOCK 11. PLAT RECORD DISTANCES WERE HELD TO ESTABLISH LOT CORNERS, AS SHOWN.

DURING THE COURSE OF THIS SURVEY, I FOUND A 1/2" IRON PIPE WHICH BEARS N.04°E., 4.30 FEET FROM THE SE CORNER OF LOT 18. I FOUND NO RECORD OF THIS PIPE EVER BEING SET AS A SURVEY MONUMENT, AND DUE TO THE FACT THAT IT IS SO FAR OUTSIDE OF ACCEPTABLE SURVEY TOLERANCE, IT WAS LIKELY SET BY A LAYMAN. I SEARCHED AROUND OTHER LOT CORNERS WITHIN THE BLOCK TO SEE IF ANY OTHER UNRECORDED OBJECTS EXIST THAT WOULD CORRELATE WITH THE PIPE, BUT FOUND NOTHING. I DO NOT ACCEPT THE PIPE AS REPRESENTING THE LOT CORNER. THE TRUE LOT CORNER WAS NOT MONUMENTED DURING THIS SURVEY, AS THE POSITION FALLS IN THE CORNER OF A ROCK RETAINING WALL.

I TIED THE CORNERS OF AN EXISTING CHAIN LINK FENCE AND STONE WALL LOCATED AROUND THE PERIMETER OF LOTS 11 AND 12. I FOUND THAT THE CENTER OF THE STONE PILLAR FENCE CORNER AGREES WITH THE RECORD LOCATION OF THE BLOCK CORNER.

NEW MONUMENTS WERE SET AT LOCATIONS ACCORDING TO THE EVIDENCE FOUND AND EVALUATED AND THE PROCEDURES OUTLINED HEREIN.

REFERENCES

RECORD MAP OF SURVEY NO.'S 9-37-1, 9-37-28, AND 9-37-267
 DEED RECORD INSTRUMENT NO.'S 6841014, 8648065, 8824036, 9220052, B12130079 AND B17310455
 PLAT OF SUMPTER HEIGHTS McEWEN'S ADDITION

REGISTERED PROFESSIONAL LAND SURVEYOR

Jason L. Hatfield

OREGON
 NOVEMBER 30, 2007
 JASON L. HATFIELD
 #69454
 EXPIRES: 6/30/2019

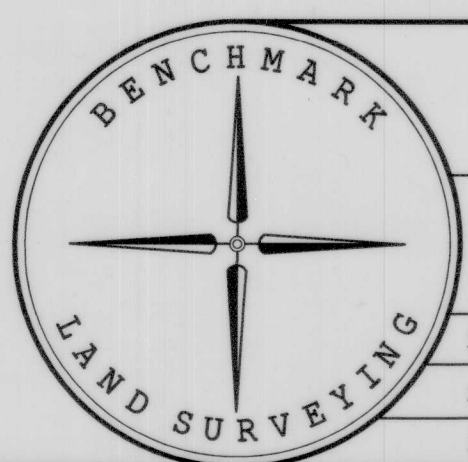

BENCHMARK LAND SURVEYING
 217 N. CANYON BLVD. JOHN DAY, OREGON
 1207 DEWEY AVE. BAKER CITY, OREGON
 541-575-1251 ~ 541-523-5852

MAP OF SURVEY LOT 18, BLOCK 11, SUMPTER HEIGHTS McEWEN'S ADDITION SITUATED IN THE SW1/4SE1/4 SECTION 29, T.9S., R.37E., W.M., CITY OF SUMPTER, BAKER COUNTY, OREGON		
SURVEYED FOR	BRUCE WARD	
SURVEYED BY	JLH	8/25/2017
SCALE: 1"=40'	DRAWN BY: JLH	

FILED Sept. 6, 2017
 BAKER COUNTY SURVEYOR
 SURVEY NO. 9-37-320