

CERTIFIED RECORD OF LAND CORNER MONUMENTATION

Corner No.5, Rainbow Lode, M.S. 447

History of original corner establishment: Corner originally ESTABLISHED by C.M.Foster, U.S.Deputy Mineral Surveyor under instructions dated Sept. 25, 1901, for mineral survey No. 447. Surveyor General records state: A tamarack post 4½ ft long 6 ins square set 18 ins in ground surrounded with a mound of earth scribed Rainbow Cor-5-447. Identical with the NE cor post of amended location, from which...A pine 8 ins dia brs S57°30'W, 5.4 ft dist blazed Rainbow 5-447-BT. A tamarack 10 ins dia brs N26°E, 11.1 ft dist blazed Rainbow-5-447-BT.

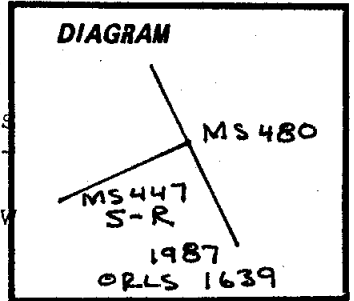

Corner RECOVERED and PERPETUATED by L.L.Myers,ORLS 699, in 1970 and his record filed with the Baker County Surveyor No.9-37-19 on Aug. 31,1977, states: Found a post with scribing and a BT, a 16" Larch which brs S26°E,11.1 ft from the down post. Set a 5/8" x 30" rebar with a 2" aluminum cap,mkd as shown above,at the point the post had centered the ground for corner. J.R.M. had placed a BT tag on the BT. Corner inaccurately REMONUMENTED by J.R.Mitchell, experienced corner recovery technician,1981 as noted below. No record filed with Baker County Surveyor and his monumented corner position is rejected this survey.

Description of corner evidence found:

A 5/8" x 30" rebar with 1½" diam aluminum cap mkd as shown beside per record of Baker County Surveyor no 9-37-19 & no 9-37-15 from which: OBT...A 18" dia western larch with fully healed blaze brs N26°E,11.1' dist per record.JRM BTs...A 7" dia white fir brs S18½°E, 5.5' dist mkd RBW 5 MS 447 BT.



Also found a 2½" brass cap on 1" galvanized iron pipe(rejected this survey) in earthen mound with 4"x4"x24" wood post alongside with scribes RAINBOW on one face - BLUE BELL on another face and MS 447 on other face brs S52°E, 3.1' dist from corner position. BC mkd as beside.

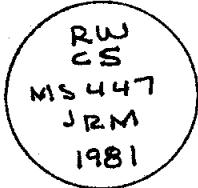

Description of monument and accessories | established to perpetuate the original location of this corner:

Rejected JRM brass cap monument and at position of rebar with 1½" diam aluminum cap...

Removed the rebar monument & replaced with 2 " x 30" aluminum pipe with 2½" aluminum cap 20" in ground surrounded with a mound of earth and stone. Set 6' steel fence post alongside with signs 54-2 & 54-9. Drove rebar below ground surface alongside aluminum cap. Cap marked as shown in corner diagram.

Painted 6" band of red around each OBT and JRM BT, also painted blaze red, and attached signs 54-3 & 54-9. Compass declination 20° East.

I hereby certify that the above corner monument was properly REMONUMENTED to U.S.F.S. standards by me and witnessed by Bill Gohring on October 23, 1987.

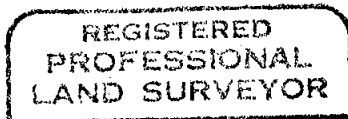

William L. Hanley

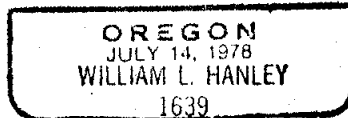

Office of.....County Surveyor..... County of.....Baker.....
 State of.....Oregon....., I hereby certify that the within instrument was filed in this office
 for record on the..... day of....., 19.....
 by
 (COUNTY OFFICIAL) (DEPUTY)