

CERTIFIED RECORD OF LAND CORNER MONUMENTATION

Corner No.6, Rainbow Lode, M.S. 447

**History of original corner establishment:**

Corner ESTABLISHED by C.M.Foster, U.S. Deputy Mineral Surveyor under instructions dated September 25, 1901, for mineral survey no 447.

Surveyor General records state: A tamarack post 4½ ft long 5 ins square set 18 ins in ground surrounded with a mound of earth scribed Rainbow Cor 6-447. Identical with the SE cor post of ammended location from which: A tamarack 16 ins in diam bears S82°50'W, 60 ft dist blazed & scribed Rainbow 6-447-BT.

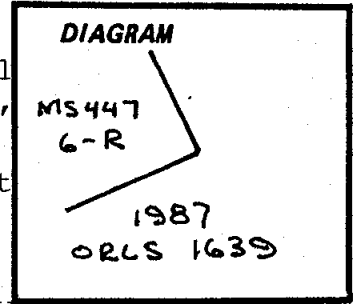

Corner RECOVERED and PERPETUATED by J.R.Mitchell, experienced corner recovery technician, as noted below. No record filed with Baker County Surveyor.

**Description of corner evidence found:**

A 2½" brass cap on 1" galvanized iron pipe in rock mound (as shown beside) with 4"x4"x30" wood post alongside with fragmentary scribes, from which:  
OBT:A 16" western larch snag stub 20' high with partially healed blaze scribed Rainbow Cor 6-447 BT. brs S87°W(record, S82°50'W), 60.0' dist per record.  
JRM BT: A white fir with bug ravaged top 11" dia brs N39°W, 14.0' dist marked RBW 6-MS447 BT.  
JRM BT: A dead white fir 7" dia brs N15½°E, 7.3' mkd RBW 6-MS447 BT on partially healed blaze.

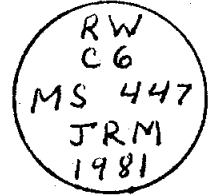

**Description of monument and accessories | established to perpetuate the original location of this corner:**

At position of JRM brass cap monument which is the best remaining evidence of original corner...

Removed brass cap monument and replaced with 2" x 30" aluminum pipe with 2½" aluminum cap 25" in ground surrounded with rock mound. Cap marked as shown in corner diagram. Set steel fence post with signs 54-2 & 54-9 attached.

**New bearing trees established:**

A western larch 15" dia brs S09°E, 33.6' dist mkd R-6-447 BT.  
A western larch 14" dia brs S50½°W, 69.9' dist mkd R-6-447 BT.

New bearing trees have a brass washer stamped PLS 1639 nailed to face of blaze. Attached signs 54-3 & 54-9 and painted face of blaze and 6" band of red paint around each BT.

Compass declination 20° East.

I hereby certify that the above corner monument was properly REMONUMENTED. to U.S.F.S. standards by me and witnessed by Bill Gohring on October 23, 1987.

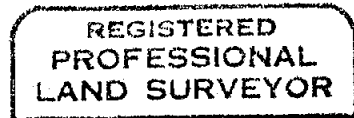

*William L. Hanley*

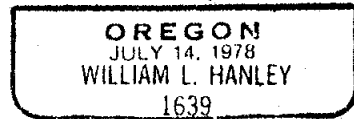

Office of.....County Surveyor..... County of.....Baker.....  
State of.....Oregon..... I hereby certify that the within instrument was filed in this office  
for record on the..... day of....., 19.....  
..... by .....  
(COUNTY OFFICIAL) (DEPUTY)

FILED 2-2-88  
BAKER COUNTY SURVEYOR  
SURVEY NO. 9-37-143