

CERTIFIED RECORD OF LAND CORNER MONUMENTATION

Z-23

History of original corner establishment:

Corner originally established in 1881 by Eugene P. McCormack under GLO Contract No. 398. Surveyor General records state: Set Post 3 ft long 3 ins square 24 ins in the ground for 1/4 sec cor marked 1/4 S on N face; from which
A Pine 24 ins diam bears N65°E 85 lks dist marked 1/4 S BT
A Pine 40 ins diam bears S55°E 30 lks dist marked 1/4 S BT

DIAGRAM

T9S R37E
1/4 $\frac{S36}{S1}$
T10S
1971
(BLM Cap)

In 1971 the BLM determined the original corner location from the remains of the original bearing trees at record bearing and distance. At the original corner location they set an I.P. 2 1/2" x 30" 24" in the ground stamped as shown in the corner diagram. They also buried a quarite stone 7" x 5" x 4" with an X chiseled on the north face.

Description of corner evidence found:

2 1/2" iron pipe with brass cap stamped as shown in corner diagram, 4" above ground. Corner monument is solid and in good condition. Bearing trees established by the BLM in 1971:
13" Ponderosa Pine, with healed blaze, bears S58°E 29 links distance.
14" Ponderosa Pine, with healed blaze, bears N3°E 68 links distance.

Original bearing trees:

Rotted, decayed Ponderosa Pine stump with no visible scribing, bears N65°E 88 links distance (Rec. 85 links).
44" Ponderosa Pine, 2' high stump with no visible scribing, bears S55°E 30 links distance.

Description of monument and accessories I established to perpetuate the original location of this corner:

Set 6' aluminum fenceposts with 54-2 and 54-9 signs 5' east and 5' west of corner monument.

New bearing trees established:

11" Ponderosa Pine bears S46°W 23.1' distance scribed 1/4 S1 BT.
12" Ponderosa Pine bears N64°W 35.2' distance scribed 1/4 S36 BT.

New bearing trees have a brass washer stamped PLS 2672 nailed to face of blaze. Attached 54-3 and 54-9 signs to each bearing tree and painted face of blaze and a 6" band around each bearing tree. The distance is measured to a 50d nail in side center of bearing trees.

Compass declination 18° East.

Date: July 24, 1997

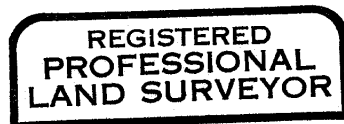

Kenneth A. Lind



Renews 12/31/98

FILED 9-9-97
BAKER COUNTY SURVEYOR
SURVEY NO. 9-37-256

Office of.....County..Surveyor..... County of.....Baker.....
State of.....Oregon....., I hereby certify that the within was filed in this office
for record on the..... day of....., 19.....
..... by
(COUNTY OFFICIAL) (DEPUTY)