

**CERTIFIED RECORD OF LAND CORNER MONUMENTATION**

**History of original corner establishment:**

Corner originally established by C.M. Foster, U.S. Deputy Mineral Surveyor under instructions dated December 7, 1899, for Mineral Survey No. 382A & B.

Surveyor General records state:

A pine post 4 ft. long 4 ins square, set 18 ins in the ground scribed 1-382-B whence: A tamarack 24 ins dia bears S18°E, 9.3 ft dist blazed and scribed 1-382-B BT. A tamarack 12 ins dia bears N62°E, 28.2 ft dist blazed and scribed 1-382-B BT.

Corner recovered and perpetuated by: J. R. Mitchell, experienced corner recovery technician, as noted below. No record filed with Baker County Surveyor.

Corner was remonumented by: William L. Hanley, per Corner Record 9-36-90, dated 2-2-88.

No trace of original pine post.

Found a 2 1/2" dia brass cap attached to a 1" dia galvanized iron pipe in rock mound from which: (brass cap mkd as shown to right & below)  
Old BT: A rotten western larch stump flush with ground brs N67°E, (record N62°E) 28.2' dist per record. No trace of tree.  
Old BT: A western larch 30" dia with fully healed blaze brs S06 1/2°E, (record, S18°E) 9.3' dist per record.  
J.R.Mitchell BT: A white fir 9" dia brs S31 1/2°E, 8.9' dist marked "1 382B BT" on partially healed blaze.

At position of JRM brass cap monument which is best available evidence of original corner postion...

Removed brass cap monument and replaced with 2" x 30" aluminum pipe with 2 1/2" aluminum cap 25" in ground surrounded with a mound of earth and stone. Set 6' steel fence post alongside. No signs attached to fence post per landowner request. Cap marked as shown in corner diagram.

Recovered original and JRM BT's signed with 54-3 - no paint or signs 54-9 attached per landowner request.

Compass declination 20° East.

I hereby certify that the above corner monmument was properly remonumented to U.S.F.S. standards by me and witnessed by Bill Gohring on October 7, 1987.

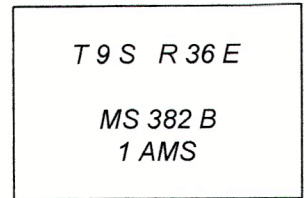

Annululu Mill Site Cor. 1

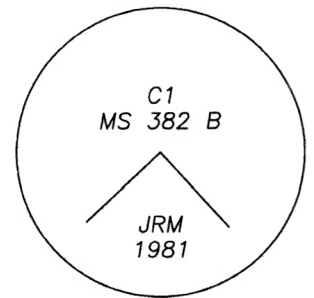

REMOVED AND REPLACED

Continued on page 2 of 2

REGISTERED PROFESSIONAL LAND SURVEYOR

*Kristina Powell*

OREGON MAY 9, 2017 KRISTINA POWELL 91201

EXPIRES 12-31-24

FILED January 3, 2024  
BAKER COUNTY SURVEYOR  
SURVEY NO. 9-36-142

**CERTIFIED RECORD OF LAND CORNER MONUMENTATION**

2 of 2

**Description of corner evidence found:**

A 2 inch aluminum pipe with 2 1/2 inch aluminum cap, marked as shown. Firmly set flush with ground, with rock collar.

From which:

The record N.E. Bearing Tree (by Foster), has been destroyed.

A 34 inch tamarack stump (by Foster) no visible scribe, bears S6 1/2°E, 9.3 feet.

A 16 inch white fir (by Mitchell) with healed blaze, bears S31 1/2°E, 8.9 feet, alive and healthy.

Monument falls West 300 feet of NF 030 Road; just East of an old goat shed and West of a new wood shed.

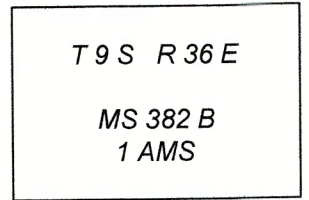

Annululu Mill Site  
Cor. 1

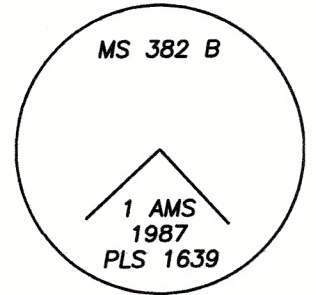

**Description of monument and accessories I established to perpetuate original location of this corner:**

New Bearing Tree:

A 19 inch white fir scribed: "C1 382-B BT", bears N21°E, 33.6 feet; measured to a 3/4 inch brass washer mkd: "LS 91201", at the right-side of tree center.

Added Bearing Tree and Land Survey Monument signs as needed.

Set a steel T-post S46°E, 5.0 ft., with two (2) signs: Property Boundary, Land Survey Monument.

Added Property Boundary sign to 14 inch white fir which bears at S42°W, 5.0 ft.

NAD 83 Geodetic Position

Lat. 44°48'24.9" N  
Long. 118°14'07.3" W

Established by: Garmin ETREX 32x

I hereby certify that the corner is monumented and accessories taken as described using a steel tape and a Warren Knight staff compass, set with a declination of 14° East.

Witnesses: David Quittschreiber, Justin Seal, Shar Hutchison

August 1, 2023

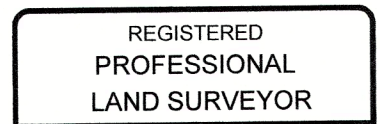

*Kristina Powell*

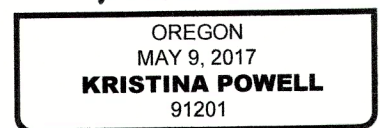

EXPIRES 12-31-24

FILED January 3, 2024  
BAKER COUNTY SURVEYOR  
SURVEY NO. 9-36-142