

BASIS OF BEARINGS
 G(WEST, 2607)
 1[N89°17'54"W 2591.75]
 [N89°17'54"W 2591.70]
 N89°17'54"W 2591.70

GOODWIN SAWMILL LANE (COUNTY ROAD NO. 1014)

NARRATIVE

THIS SURVEY WAS PERFORMED AT THE REQUEST OF KELLY PREMO. THE PURPOSE OF THIS SURVEY WAS TO MONUMENT A PROPOSED PROPERTY LINE ADJUSTMENT BETWEEN A TRACT OF LAND OWNED BY KELLY PREMO AND KATHY CALLANTINE, DESCRIBED IN DEED NO. B03 50 0207, AND A TRACT OF LAND OWNED BY NEIL CARLSON, DESCRIBED IN DEED NO. B14 02 0063. THIS PROPERTY LINE ADJUSTMENT WAS APPROVED BY THE BAKER COUNTY PLANNING DEPARTMENT ACCORDING TO ADMINISTRATIVE REPORT AND DECISION PLA-19-102.

A SEARCH WAS MADE OF THE AVAILABLE RECORDS PERTAINING TO THIS SURVEY. FIELD MEASUREMENTS WERE MADE TO LOCATE CONTROLLING MONUMENTS FROM SURVEY NO. 8-46-49, WHICH WERE FOUND AND ACCEPTED. AT THE SOUTH 1/4 CORNER OF SECTION 6, I FOUND THE ORIGINAL MARKED STONE WHICH WAS PREVIOUSLY RECOVERED IN SURVEY NO. 8-46-49. THE STONE WAS FOUND LYING WITH THE MARKED FACE UP IN A NORTH-SOUTH FENCE LINE, AT THE BASE OF TWO LARGE COTTONWOOD TREES. BENEATH THE STONE, I FOUND A BRIDGE SPIKE DRIVEN IN THE GROUND, WHICH I TIED FOR THE TRUE CORNER POSITION. TO REMONUMENT THIS CORNER WILL REQUIRE FALLING ONE OR BOTH OF THE TREES. THEREFORE, I LEFT THE STONE IN PLACE AND SET TWO REFERENCE MONUMENTS TO HELP PERPETUATE THE LOCATION. SEE THE CORNER MONUMENTATION REPORT FILED SEPARATELY FOR MORE DETAILS.

THE PREMO-CALLANTINE PROPERTY IS JUNIOR TO THE MCLELLAN PROPERTY ON THE WEST, AND IS ALSO JUNIOR TO THE THOMAS PROPERTY ON THE EAST. THE MCLELLAN PROPERTY IS DESCRIBED IN DEED NO. B17 50 0060, AND WAS ORIGINALLY DESCRIBED IN DEED BOOK 148 PAGE 458. THE EAST AND WEST LINES ARE PARALLEL TO THE CORNUCOPIA HIGHWAY TANGENT, WHICH I DETERMINED BY LOCATING THE EXISTING HIGHWAY CENTERLINE. I HELD THE DEED RECORD DISTANCE OF 276 FEET MEASURED EASTERLY ALONG THE SECTION LINE FROM THE 1/16 CORNER TO DETERMINE THE NORTHWEST CORNER OF THE PREMO-CALLANTINE PROPERTY. FROM THIS POINT, I RAN SOUTHEASTERLY AND PARALLEL TO THE CORNUCOPIA HIGHWAY THE DEED RECORD DISTANCE OF 472 FEET TO DETERMINE THE SOUTHWEST CORNER OF THE PREMO-CALLANTINE PROPERTY. I THEN RAN EASTERLY AND PARALLEL TO THE SECTION LINE TO INTERSECT THE WEST LINE OF THE THOMAS PROPERTY DESCRIBED IN DEED NO. B04 42 0042.

THE RIGHT OF WAY FOR GOODWIN SAWMILL LANE AS IT PERTAINS TO THIS SURVEY IS DESCRIBED IN DEED NO.'S 66 24 022, 66 24 023 AND 66 25 011. THE COUNTY ROAD CENTERLINE DIVERGES FROM THE SECTION LINE GOING WEST FROM THE NORTH 1/4 CORNER OF SECTION 6, AS SHOWN HEREON.

NEW MONUMENTS WERE SET AT LOCATIONS ACCORDING TO THE EVIDENCE FOUND. THE PROPOSED LOCATION OF THE NEW PROPERTY LINE WAS POINTED OUT TO ME BY MR. PREMO.

REFERENCES

- RECORD MAP OF SURVEY NO.'S 8-46-49 AND 8-46-112
- DEED RECORD INSTRUMENT NO.'S 66 24 022, 66 24 023, 66 21 042, 66 25 011, B03 50 0207, B04 42 0042, B14 02 0063, B17 50 0060 AND B19 27 0072
- GENERAL LAND OFFICE FIELD NOTES

LEGEND

- ◆ FOUND ORIGINAL MONUMENT AS NOTED. NOT REMONUMENTED THIS SURVEY. SEE NARRATIVE
- FOUND 2 1/2" COUNTY SURVEYOR BRASS DISC FLUSH WITH ASPHALT ROAD SURFACE
- FOUND 1/2" IRON PIN WITH NO CAP FROM SURVEY NO. 8-46-49
- SET 5/8"x30" IRON PIN WITH ATTACHED YELLOW PLASTIC CAP MARKED BENCHMARK SURVEYING
- () DEED RECORD BEARING AND DISTANCE
- G() G.L.O. RECORD BEARING AND DISTANCE
- [] RECORD BEARING AND DISTANCE FROM SURVEY NO. 8-46-49
- 1[] RECORD BEARING AND DISTANCE FROM SURVEY NO. 8-46-112
- PROPERTY LINE AFTER ADJUSTMENT
- x-x FENCE LINE

LINE TABLE

| LINE | BEARING | DISTANCE |
|------|-------------|----------|
| L1 | N40°28'19"W | 42.30 |
| L2 | S04°00'00"E | 33.18 |
| L3 | S36°25'00"E | 44.47 |

REGISTERED PROFESSIONAL LAND SURVEYOR

Jason L. Hatfield

OREGON
 NOVEMBER 30, 2007
 JASON L. HATFIELD
 #69454

EXPIRES: 6/30/2021

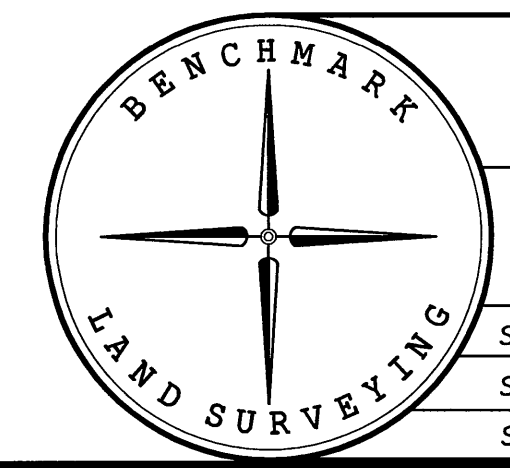

BENCHMARK LAND SURVEYING
 217 N. CANYON BLVD. JOHN DAY, OREGON
 1207 DEWEY AVE., BAKER CITY, OREGON
 541-575-1251 ~ 541-523-5852

MAP OF SURVEY
 PROPOSED PROPERTY LINE ADJUSTMENT
 SITUATED IN GOVERNMENT LOT 3 SECTION 6, T.8S., R.46E., W.M., BAKER COUNTY, OREGON

| | | |
|----------------|---------------|------------|
| SURVEYED FOR | KELLY PREMO | |
| SURVEYED BY | JLH | 11/22/2019 |
| SCALE: 1"=100' | DRAWN BY: JLH | |

BASIS OF BEARINGS

RECORD MAP OF SURVEY NO. 8-46-49
 THE NORTH LINE OF THE NW1/4 SECTION 6
 BEARS N89°17'54"W, AS SHOWN

FILED December 4, 2019
 BAKER COUNTY SURVEYOR
 SURVEY NO. 8-46-165

1/4 CORNER SEC. 6: FOUND A STONE 15"x7"x6" (G.L.O. RECORD: 18"x8"x6") MARKED "1/4" LYING WITH THE MARKED FACE UP IN A NORTH-SOUTH FENCELINE. ALSO FOUND A BRIDGE SPIKE WITH FLAGGING ATTACHED SET BENEATH THE STONE. I DID NOT REMONUMENT THIS CORNER, BUT I SET TWO ACCESSORIES. SEE MONUMENTATION SHEET FILED SEPARATELY FOR DETAILS.