

# RECORD OF LAND CORNER MONUMENTATION

**CORNER:** WEST 1/16 COR. SECTION 4, T. 8 S., R. 46 E., W.M.

**PREVIOUSLY ESTABLISHED BY:** James Hanley, P.E.

Baker County Survey No. 8-46-16

Filed July 12, 1974

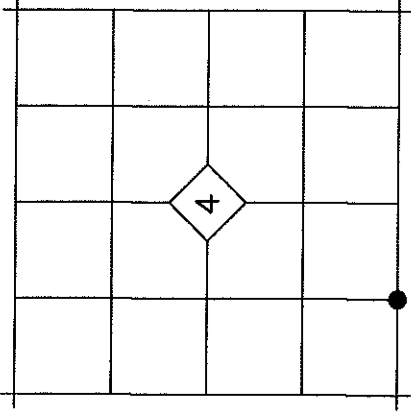

**HANLEY'S 1974 DESCRIPTION:** Notation at corner: "SET 1/2" REBAR 5.0' EAST OF FENCE INTERSECTION"

**EVIDENCE FOUND:** Found a 1/2" iron pin with no cap, which bears N.03°W., 4.14 feet from the 1/16 Corner position determined midway between found accepted monuments at the SW Corner and South 1/4 Corner Section 4. I found no direct evidence in the field of landowner reliance on the position of the found pin. I do not accept the found pin for the position of the 1/16 Corner.

## DESCRIPTION OF MONUMENTS AND ACCESSORIES SET AND METHODS USED:

At the corner point as determined by survey, I set a 5/8"x24" iron pin with attached 2" aluminum cap 22" in the ground. Cap is marked as shown below.

From which, I SET THE FOLLOWING NEW REFERENCE POINTS:

- ▶ A 5/8"x24" iron pin bears N.45°01'E., 31.88 ft. with attached yellow plastic cap marked BENCHMARK SURVEYING flush with the ground.
- ▶ A 5/8"x24" iron pin bears S.44°59'E., 31.85 ft. with attached yellow plastic cap marked BENCHMARK SURVEYING flush with the ground.

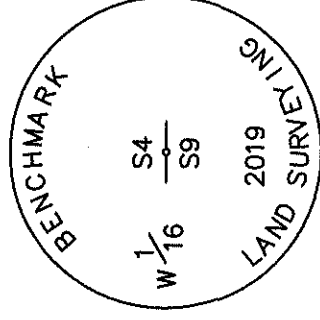

Used a total station to measure the reference points. Bearings are based on associated Map of Survey dated August 27, 2019.

Work Performed August 15, 2019 by:

Jason L. Hatfield, PLS

BENCHMARK LAND SURVEYING, INC.

1207 Dewey Avenue

Baker City, OR 97814

(541) 523-5852

www.benchmarkls.com

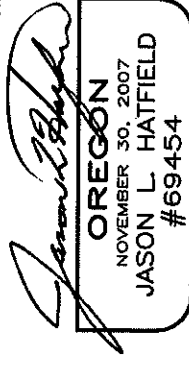

FILED September 4, 2019

BAKER COUNTY SURVEYOR

SURVEY NO. 8-46-163

EXPIRES: 6/30/2021