

**LEGEND**

- ⊙ Found as noted
- Set 5/8 inch x 30" rebar w/ plastic cap marked "HANLEY ENGR. PLS 1206"
- Set 10.0 feet reference on line 5/8" x 30" rebar with cap mkd. "HANLEY ENGR. PLS 1206"

**NARRATIVE**

The purpose of this survey of the Stockmen's Cafe property for Robert D. and Susan M. Stewart is to mark on the ground with proper monumentation the corners of the parcel described in Deed 97-40-102.

Recovery was made of the Main Street and Record Street intersection monument, the Southeast corner of Section 16 brass disc, the South quarter section corner brass disc, Center Street-Record Street intersection monument, various survey marks in sidewalk along the Northerly side of Main Street.

The point of beginning for record description is 237 feet along a line bearing N. 22° 45' W. from the intersection of the centerline of Record Street with the East line of Main St. This was an iron pin established by engineer Philo H. Anderson and used for control basis of most of the surveyed descriptions in this area. The pin no longer exists, I believe it was destroyed when a new section of sidewalk and water meter was constructed. The Anderson pin original location is replaced with a 5/8" rebar, from other ties and references. It marks the Southwest corner of the subject property.

The original description of this property included land lying East which was then excluded is shown hereon. The Northerly line of the parcel contains an angle point which places this point in encroachment on T.L. 2100 about 6.02 feet. It shows an inverse bearing of S. 76° 13' 48" W., 238.43 feet between the adjacent Northerly corners.

**MAP OF SURVEY**  
 A PARCEL IN THE S 1/2 SE 1/4 SEC. 8, T.8S, R.46E., W.M.  
 STOCKMEN'S INC. PARCEL  
 HALFWAY, OREGON  
 Surveyed April 4-30, 1998  
 SCALE: 1" = 50'

FILED June 15, 1998  
 BAKER COUNTY SURVEYOR  
 SURVEY NO. 8-46-76

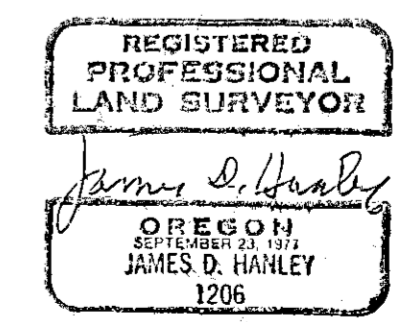

HANLEY ENGINEERING  
 2043 MAIN STREET  
 BAKER CITY, OREGON

Renews June 30, 1999

REVISED 6-15-98