

PUBLIC LAND SURVEY CORNER RECORD  
MALHEUR COUNTY, OREGON

Township 8 S, Range 46 E, Section 24, Corner E 1/4

CORNER EVIDENCE FOUND (INCLUDING ACCESSORIES): NO CORNER EVIDENCE FOUND.

CORNER LOCATION DETERMINED BY SINGLE PROPORTION AFTER THE NORTHEAST CORNER AND THE SOUTHEAST CORNER LOCATIONS WERE DETERMINED

Description of New Monument, Accessories, or Changes: \_\_\_\_\_

SET ALUMINUM CAP WITH FENO MONUMENT. MONUMENT SET FLUSH WITH THE GROUND AND MARKED AS SHOWN.

Monument Detail

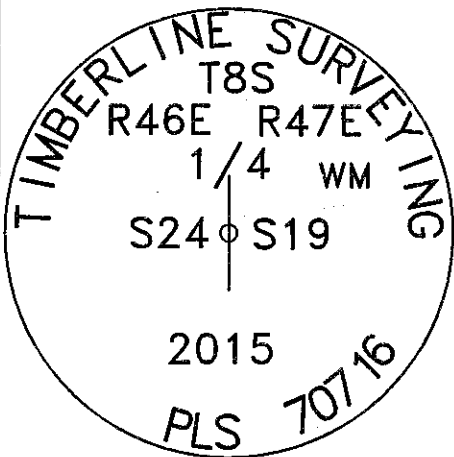

ALUMINUM CAP

Sketch of General Area and Accessories

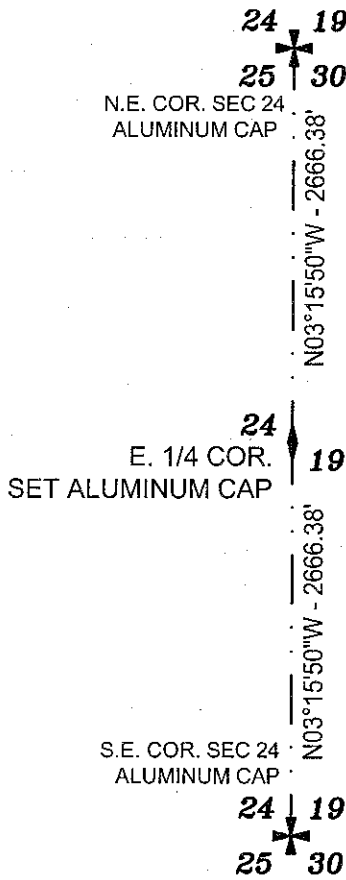

Stamp

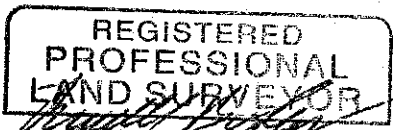

7/9/15

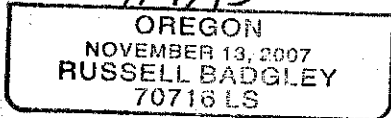

Exp. 12/31/15

Bus. Name and Address

TIMBERLINE SURVEYING

847 PARCKCENTRE WAY STE. 3

NAMPA, IDAHO 83651

Date of Field Work:

JUNE 30, 2015

Diagram

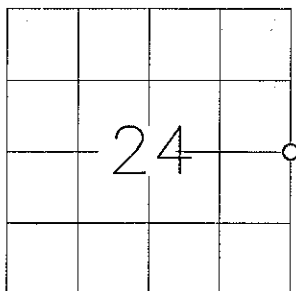

For County Use Only

Received \_\_\_\_\_

Filed \_\_\_\_\_

Sur. No. \_\_\_\_\_

Dwg. No. \_\_\_\_\_

Index. No. P-25

FILED July 17, 2015

BAKER COUNTY SURVEYOR

SURVEY NO. 8-46-132/8-47-7