

CERTIFIED RECORD OF LAND CORNER MONUMENTATION

History of original corner establishment:

NONE

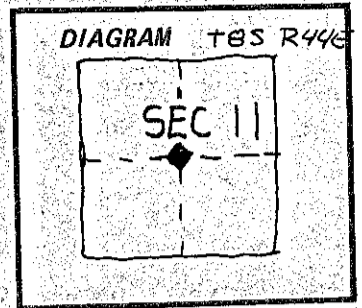

Description of corner evidence found:

NONE

Description of monument and accessories established to perpetuate the original location of this corner:

Corner falls in plowed field thus;

Set 1/2"x26" aluminum pipe with 3-1/4" aluminum cap. 18" below ground surface. Drove 5/8"x30" iron rod beneath aluminum pipe.

Set 6' Steel Post 54.4 feet West in N-S fence with 54-3 sign.

Witness by: R. J. Schulson
B. Haynes

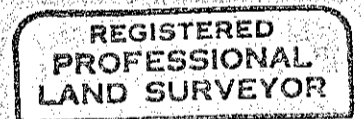
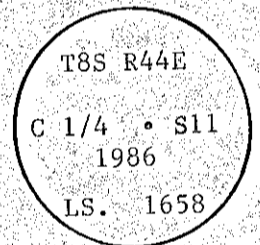

6-30-86
Ronald W. Schulson

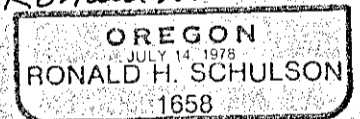

Office of..... County of Baker
State of....., I hereby certify that the within instrument was filed in this office
for record on the..... day of....., 19.....

..... by
(COUNTY OFFICIAL) (DEPUTY)