

RECORD OF SURVEY

SECTION 9, T.8S., R.44E., W.M.

BAKER COUNTY, OREGON

"SPARTA CADASTRAL SURVEY"

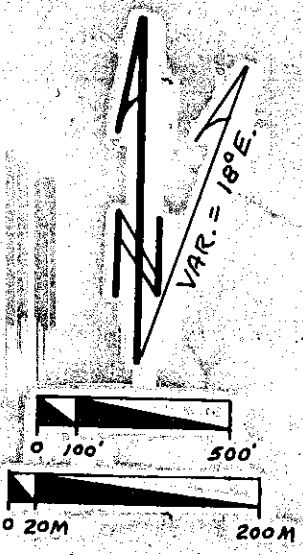

T8S R44E
S8 | S9
S17 | S16
1974

(A) SECTION CORNER COMMON TO SECTIONS 8, 9, 16 & 17.
 FOUND: 2" I.P. & B/C in M.O.S. and the following BT's:
 19" P.P., N62°29'E, 67.0 feet;
 15" P.P., S66°52'E, 38.7 feet;
 19" P.P., S00°08'W, 75.7 feet;
 19" P.P., N43°57'W, 34.7 feet;
 19" PINE stump, S81°59'W, 18.1 feet.

T8S R44E
S9 | S10
S16 | S15
1985
LS 1658

(B) SECTION CORNER COMMON TO SECTIONS 9, 10, 15 & 16.
 FOUND: A four way fence corner but no trace of stone or stone mound. Since Collins in 1924 called for a stone and stone mound at a four way fence corner and since his topography and calls fit well, I held the alignment of the four fences as the best evidence of this corner.
 SET: 2" A.P. in M.O.S. and the following:
 5/8"x30" iron rod with A.C., N50°04'E, 15.35 feet, mkd."RM 15.35"
 5/8"x30" iron rod with A.C., S00°44'E, 62.24 feet, mkd."RM 62.24"
 5/8"x30" iron rod with A.C., S87°40'W, 12.41 feet, mkd."RM 12.41"
 5/8"x30" iron rod with A.C., N12°08'W, 18.06 feet, mkd."RM 18.06"

T8S R44E
1/4 S 9
S16
CS 1976

(C) 1/4 CORNER COMMON TO SECTIONS 9 AND 16.
 FOUND: 2" I.P. & B/C in M.O.S. and the following:
 28" P.P., N65°45'E, 105.5 feet;
 26" P.P., S42°45'E, 145.5 feet.
 Corner is on North side of a fence jack with fences running E, W & S.

SW 1/4
WW NF

SE 1/4
WW NF

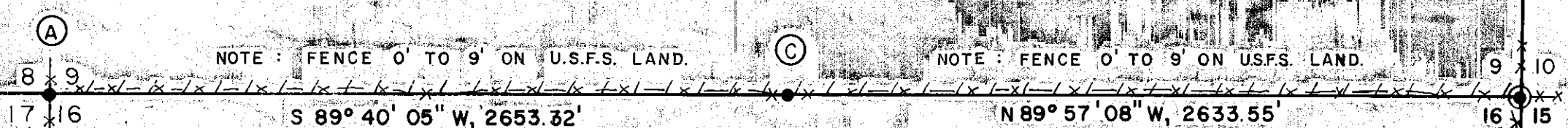

NOTE: FENCE 0' TO 9' ON U.S.F.S. LAND.

NOTE: FENCE 0' TO 9' ON USFS. LAND.

S 89° 40' 05" W, 2653.32'
 (BARR, S 89° 58' W, 39.92)
 (COLLINS, S 89° 47' W, 39.87 CH)

N 89° 57' 08" W, 2633.55'
 (BARR, S 89° 58' W, 39.92 CH.)
 (COLLINS, S 89° 50' W, 39.92 CH.)

PVT
NW 1/4

PVT
NE 1/4

T8S R44E
1/4
S9 | S10
1985
LS 1658

(D) 1/4 CORNER COMMON TO SECTIONS 9 & 10.
 FOUND: An unrecorded iron rod, stone and evidence of the original BT's.
 SET: 2" A.P. 28" in the ground at the record distance from the BT's, and buried the unrecorded marked stone on the West side of the A.P. from which bear:
 (40" Pine, N58°E, 64.7 feet.) Now stump hole; N58°53'E, 64.7 ft.
 (40" Pine, N17°W, 29.7 feet) Now 36" stump with outer wood where scribe would have been rotted away.
 N16°33'W, 29.7 feet to estimated face.
 10" P.P., S60°W, 14.8 feet, mkd., "1/4 S9 BT";
 18" P.P., S50°45'E, 36.0 feet, mkd., "1/4 S10 BT".
 The found 5/8" iron rod bears N42°44'E, 1.39 feet.

T8S R44E
1/4
S16 | S15
CS 1976

(E) 1/4 CORNER COMMON TO SECTIONS 15 & 16.
 FOUND: 1" I.P. & B/C with 1 foot diameter gear around I.P.
 SET: 7" D.F., N79°15'E, 21.4 feet, mkd., "1/4 S15 BT";
 22" D.F., N78°30'W, 70.4 feet, mkd., "1/4 S16 BT".

N 00°33'40" E, 2715.64'
 (NORTH, 40.00 CH = 2640.00')

 N 00°00'18" W, 2653.63'
 (N 40.00 = 2640.00, BARR, 1881)
 (N 40.16 = 2650.56, COLLINS, 1924)

LEGEND

- = CORNER ESTABLISHED OR RE-ESTABLISHED BY THIS SURVEY. SET A 2-3/8" (OD) x 30" ALUMINUM PIPE WITH A 3-1/4" ALUMINUM CAP STAMPED AS SHOWN HEREON. SAID PIPES CONTAIN A MAGNET SO THAT THEY MAY BE DETECTED ELECTRONICALLY. WHERE AVAILABLE, I MARKED BEARING TREES AS SHOWN HEREON, ATTACHED A BRASS WASHER MARKED "LS 1658" NEAR THE BOTTOM OF THE FACE OF EACH BT, PAINTED FACES WITH RED PAINT, SMOOTHED THE BARK AND PAINTED A 6" RED BAND AROUND EACH BT AT APPROXIMATELY 5 1/2 FOOT HEIGHT AND ATTACHED THE APPROPRIATE U.S.F.S. SIGNS. DISTANCES ARE TAKEN TO THE CENTER OF THE TREE JUST ABOVE THE ROOT CROWN UNLESS NOTED OTHERWISE.
- = CORNER EVIDENCE FOUND, CORNER RESTORED WITH SAME MONUMENT AND ACCESSORIES AS SHOWN ABOVE.
- = CORNER FOUND AS NOTED. ALL SUCH CORNER WERE MAINTAINED TO ABOVE STANDARDS.
- () = DATA OF RECORD, GLO OR AS NOTED.
- ||||| = U.S.F.S. BOUNDARY, MARKED WITH 6 FOOT STEEL FENCE POSTS & BOUNDARY SIGNS.
- X--X--X = EXISTING FENCE LINE EVIDENCE.
- U.S.F.S. = U.S. FOREST SERVICE.
- M.O.S. = MOUND OF STONE.
- PVT. = PRIVATE LANDS.
- B.T. = BEARING TREE.
- OD or ID = OUTSIDE or INSIDE DIAMETER.
- DECL. = STAFF COMPASS DECLINATION USED.
- Mkd. = MARKED.
- TAM. = TAMARACK.
- W.W.N.F. = WALLOWA WHITMAN NATIONAL FOREST.
- GLO = GENERAL LAND OFFICE.
- P.P. = PONDEROSA PINE.
- L.P. = LODGEPOLE PINE.
- JUN. = JUNIPER.
- I.P. = IRON PIPE.
- CH. = CHAINS.
- B/C = BRASS OR BRONZE CAP.
- A.P. = ALUMINUM PIPE.
- D.F. or W.F. = DOUGLAS OR WHITE FIR.

NARRATIVE

THE PURPOSE OF THIS SURVEY WAS TO ESTABLISH ALL U.S. FOREST SERVICE BOUNDARIES SHOWN HEREON. TO DO SO ALL EXTERIOR SECTION AND 1/4 SECTION CORNERS WHICH WERE NEEDED FOR CONTROL WERE RECOVERED OR RE-ESTABLISHED AND THE U.S. FOREST SERVICE BOUNDARIES MARKED WITH 6 FOOT STEEL FENCE POSTS AND SIGNS.
 THE SURVEY WAS CONDUCTED USING A 10" TOPCON OR 1" JENA THEODOLITE AND MCHERRY EDM. REFERENCE MATERIALS USED WERE AS FOLLOWS: 1. GENERAL LAND OFFICE RECORDS, BOTH ORIGINAL AND RETRACEMENTS, ESPECIALLY THE SURVEY BY J. COLLINS IN 1924, SINCE HIS CALLS APPEAR TO HAVE BEEN QUITE ACCURATE. 2. RESTORATIONS BY: BLM; THE BAKER COUNTY SURVEYOR, JAMES HANLEY; THE WALLOWA COUNTY SURVEYOR, VERNE RUSSELL; JAMES HAMBLETON, 1865, AND H. HILDEBRAND, 1898.
 BEARINGS USED HEREON ARE TRUE, BASED UPON A SOLAR OBSERVATION TAKEN APPROXIMATELY 500 FEET EAST OF THE SOUTHEAST CORNER OF SECTION 9.

HISTORY

THE ORIGINAL GENERAL LAND OFFICE SURVEY WAS CONDUCTED BY W. BARR IN 1881. THE SOUTH LINE OF SECTION 9 WAS RETRACED BY J. COLLINS IN 1924 AT WHICH TIME HE RETRACED THE EXTERIOR OF SECTIONS 16 & 17 TO DO A MINERAL SEGREGATION SURVEY. VARIOUS RESTORATIONS WERE DONE BY THOSE SURVEYORS MENTIONED IN THE NARRATIVE.

I, Ronald H. Schulson, Registered Land Surveyor No. 1658 in the State of Oregon, on this 30TH day of APRIL, 1986, do hereby certify that this map and the notes hereon or attached, is a correct representation of a survey I performed during JUNE 1985 through APRIL, 1986, at the request of the USDA, FOREST SERVICE, in accordance with the Statutes of the State of Oregon and with the articles of my contract.

Ronald H. Schulson
 RONALD H. SCHULSON

REGISTERED
 PROFESSIONAL
 LAND SURVEYOR

Ronald H. Schulson
 OREGON
 JULY 12, 1982
 RONALD H. SCHULSON
 1658

FILED 7-16-86
 BAKER COUNTY SURVEYOR
 SURVEY NO. 8-44-109

RECORD OF SURVEY PREPARED FOR AND AT THE REQUEST OF WALLOWA-WHITMAN NATIONAL FOREST	J & R No. S-8620 SCALE: 1" = 500' DATE: APRIL 30, 1986
J & R SURVEYORS P.O. BOX 418, DALLAS, OR. 97338 TELEPHONE: (503) 623-4003	FIELD BOOK NO. 1 CONTRACT NO. 53-04H1-4-9624N
TAX LOT OR D.L.C. SWSE 1/4 sec. 9 T. 8 S. R. 44 W.M., BAKER COUNTY	