

CERTIFIED RECORD OF LAND CORNER MONUMENTATION

History of original corner establishment:

(Hoffman survey of 1914, set basalt stone 14"x8"x6" mkd. "C $\frac{1}{4}$ " on top.

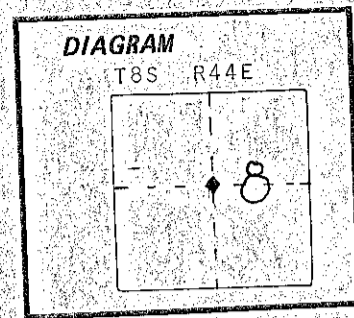

Description of corner evidence found:

Area N. of fence has been dozed. Could not find stone. A fence corner is S48°W, 15.4'; fences running S and E.

Description of monument and accessories I established to perpetuate the original location of this corner:

Set 2"x30" alum. pipe with 3 $\frac{1}{4}$ " alum. cap 29" in the ground.
 No stone available.
 7" Ponderosa Pine N61°56'W, 58.4', mkd., "C $\frac{1}{4}$ S8 BT".
 7" Ponderosa Pine N13°51'E, 204.2', mkd., "C $\frac{1}{4}$ S8 BT".
 Set 6' steel post 1' N with 54-9 sign.
 Each BT has a 6" red painted band and face and brass LS washer and signs 54-9 and 54-3.
 Witnessed by J. David Brinton, LS #2065.

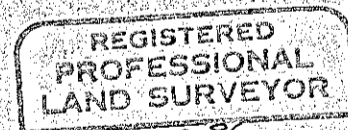
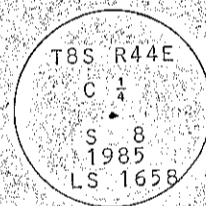

4-30-80
Ronald H. Schulson

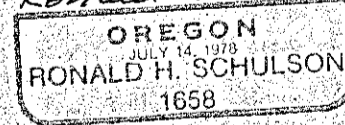

Office of..... County of..... Baker.....
 State of..... I hereby certify that the within instrument was filed in this office
 for record on the..... day of....., 19.....
 by
 (COUNTY OFFICIAL) (DEPUTY)

Form R6-7100-57 (9/71)

*GPO-798-276
 FILED June 16, 1980
 BAKER COUNTY SURVEYOR
 SURVEY NO. 8-44-92