

CERTIFIED RECORD OF LAND CORNER MONUMENTATION

History of original corner establishment:

(Survey by Ira Hoffman in 1914, set basalt stone, 12"x8"x6" with "1/16" on E face).

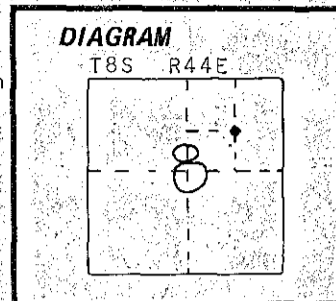

Description of corner evidence found:

Found stone 16"x10"x6" lying disturbed approx. 50' S and has been pushed by a dozer.

Marks, "1/16" visible.

Description of monument and accessories established to perpetuate the original location of this corner:

Set 2"x30" alum. pipe with 3 1/4" alum. cap 15" in the ground and erected a mound of stone around pipe. Placed Hoffman's stone on W. edge of mound of stone.

24" Ponderosa Pine N66°43'E, 150.1', mkd., "NE 1/16 S8 BT".

19" Ponderosa Pine S60°41'E, 153.0', mkd., "NE 1/16 S8 BT".

Set 6' steel post 6' W with signs 54-9 and 54-2.

Each BT has a 6" red painted band and face and brass LS washer and 54-9 and 54-3 signs.

Fence corner bears N11°W, 80'. Fence runs S-W & N.

Witnessed by P. Leigh.

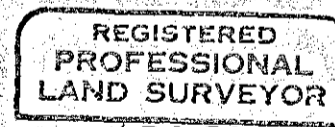
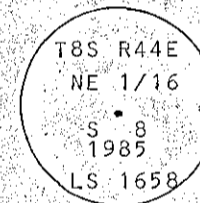

4-30-86

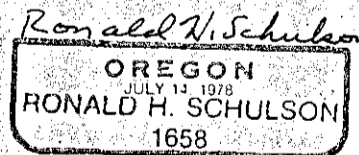

Office of..... County of..... Baker
 State of..... I hereby certify that the within instrument was filed in this office
 for record on the..... day of....., 19.....
 by
 (COUNTY OFFICIAL) (DEPUTY)

FILED June 16 1986
 BAKER COUNTY SURVEYOR
 SURVEY NO. 8-44-91