

**CERTIFIED RECORD OF LAND CORNER MONUMENTATION**

**DIAGRAM**

**History of original corner establishment:**

The original corner was set by J.H. Stone, Deputy Surveyor, under Contract No. 235, dated July 6, 1875.

The original notes state:  
Set Stone 14 x 12 x 10 for 1/4 Sec. Cor.

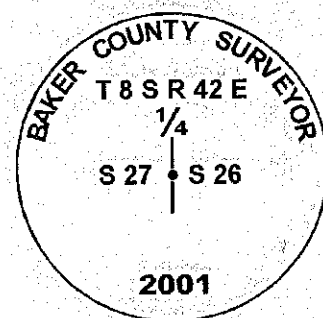

**Description of corner evidence found:**

An extensive search was made for the original stone. No original corner evidence found. Found a drilled nail set in a horizontal fence post at fence intersection. Fences run East and South from intersection. See Narrative for Baker County Survey No. 8-42-15 for explanation of the origin of the drilled nail.

**Description of monument and accessories I established to perpetuate the original location of the corner:**

The corner was reestablished at the position occupied by said drilled nail, directly under the horizontal fence post. Set a 2 1/2" diameter brass cap on a 1" x 30" galvanized pipe, approximately 6" exposed and surrounded with stones. The cap is marked as shown in the corner diagram.

No corner monument references were set at this time.

Reference survey: Baker County Survey No. 8-42-15.

I, Thomas J. Hanley certify that this corner was properly reestablished as witnessed by Kirby Danford and Asa Langrell on June 29, 2001.

FILED December 7, 2001  
BAKER COUNTY SURVEYOR  
SURVEY NO. 8-42-14  
CORNER PRES. NO. ~~CP #71~~ CP# 72

