

RECORD OF LAND CORNER MONUMENTATION

CORNER: SOUTHEAST COR. SECTION 35, TWP. 8 S., RANGE 40 E., W.M.

ORIGINAL SURVEY BY: Timothy W. Davenport, U.S. Deputy Surveyor

CONTRACT NUMBER: 102

CONTRACT DATE: July 20, 1863

SUBSEQUENT SURVEYS:

- Baker County Survey No. 9-40-13 by James Hanley, PE, filed Feb. 22, 1973
- Baker County Survey No. 9-40-25 by James Hanley, PE, filed April 6, 1977
- Baker County Survey No. 9-40-558 by Tom Hanley, PLS, Filed Sept. 23, 2002

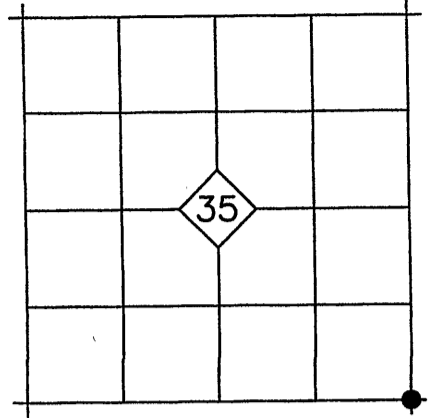

ORIGINAL DESCRIPTION: *Set post corner to Secs 1, 2, 35 & 36 made mound of earth and drove charred stake as per inst.*

Baker County Survey No. 9-40-13: Notation at corner states *"Found mon each side (E&W of cor. location in co.rd.fc.lines. Origin unknown"*

Baker County Survey No. 9-40-25: Notation at corner states *"Found 2 iron pin ref. mon. 1 each E.&W. of sec. cor. location"*

Baker County Survey No. 9-40-558: Notation at corner states *"Found two 5/8" rebar reference monuments per Ba. Co. Sur. No. 9-40-25. West ref. mon. bears S.89°36'04"W., 28.85', and the east ref. mon. bears N.89°16'05"E., 28.91' from the section corner."*

EVIDENCE FOUND: I found the east reference monument, which is a 5/8" rebar with no cap in the east right of way fence. I also found the west reference monument, also a 5/8" rebar with no cap, which was badly bent and out of position. Although the origin of these monuments is unknown, they have been utilized as references to the section corner on Survey No.'s 9-40-13, 9-40-25 and 9-40-558. I reestablished the section corner at the record bearing and distance of S.89°16'05"W., 28.91 feet from the east reference monument. I also found an unrecorded 1/2" iron pin with yellow cap (illegible markings) 0.14' North and 0.20' East, which is not accepted. The top of this pin is 1 foot below the asphalt surface.

DESCRIPTION OF MONUMENTS AND ACCESSORIES SET AND METHODS USED:

At the corner point, I set a 5/8"x24" iron pin with attached 2" aluminum cap 30" in the ground. Top of cap is 6" below the asphalt road surface. Cap is marked as shown below. I left the unrecorded 1/2" pin in place.

From which, I SET THE FOLLOWING NEW REFERENCE POINTS:

- ▶ A 5/8"x30" iron pin bears S.46°40'E., 41.01 ft. with attached yellow plastic cap marked BENCHMARK SURVEYING.
- ▶ A 5/8"x30" iron pin bears S.47°47'W., 39.38 ft. with attached yellow plastic cap marked BENCHMARK SURVEYING.
- ▶ A 5/8"x30" iron pin bears N.26°46'W., 67.37 ft. with attached yellow plastic cap marked BENCHMARK SURVEYING.

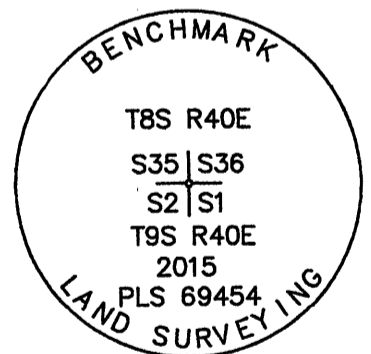

Used RTK GPS to measure the reference points. Bearings are based on Baker County Survey No. 8-40-14.

RESTORATION BY, STAMP AND DATE:

Work Performed December 29, 2015 by:

Jason L. Hatfield, PLS
Michael C. Springer, PLS

BENCHMARK LAND SURVEYING, INC.
2101 Main Street
Baker City, OR 97814
(800) 699-0516
www.benchmarkls.com

JAN 22 2016
BENCHMARK SURVEYOR
SURVEY NO. 8-40-40
9-40-745

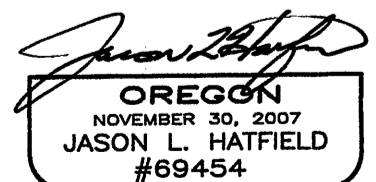
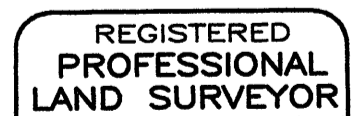

EXPIRES: 6/30/2017