

RECORD OF LAND CORNER MONUMENTATION

CORNER: SOUTH 1/4 COR. SECTION 35, TWP. 8 S., RANGE 40 E., W.M.

ORIGINAL SURVEY BY: Timothy W. Davenport, U.S. Deputy Surveyor

CONTRACT NUMBER: 102

CONTRACT DATE: July 20, 1863

SUBSEQUENT SURVEYS: Baker County Survey No. 9-40-25 by
James Hanley, PE, filed April 6, 1977

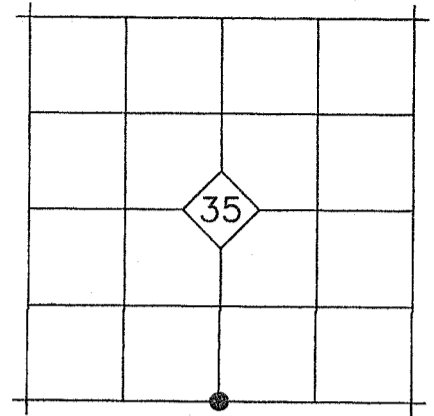

ORIGINAL DESCRIPTION: *Set qr Sec post and made mound of earth and drove charred stake as per inst.*

SURVEY NO. 9-40-25: Set 2½" brass cap monument "apportioned location"

EVIDENCE FOUND: We found a 1½" pipe with 2½" brass cap from Survey No. 9-40-25 laying on the ground and bent. It appeared that it had been pulled out of the ground by heavy equipment. As there were no references of record for this corner, I reestablished the position by single proportionate measure between the found monument at the southwest corner of Section 35 and the reestablished monument at the Southeast corner of Section 35.

DESCRIPTION OF MONUMENTS AND ACCESSORIES SET AND METHODS USED:

At the corner point, I set a 5/8"x30" iron pin with attached 2" aluminum cap 30" in the ground. Cap is marked as shown below.

From which, I SET THE FOLLOWING REFERENCE POINTS:

- ▶ A 5/8"x30" iron pin bears N.59°06'E., 23.05 ft. with attached yellow plastic cap marked BENCHMARK SURVEYING.
- ▶ A 5/8"x30" iron pin bears S.45°06'E., 28.64 ft. with attached yellow plastic cap marked BENCHMARK SURVEYING
- ▶ A 5/8"x30" iron pin bears S.28°58'W., 13.14 ft. with attached yellow plastic cap marked BENCHMARK SURVEYING, in a North-South fence.
- ▶ A 5/8"x30" iron pin bears N.24°01'W., 17.12 ft. with attached yellow plastic cap marked BENCHMARK SURVEYING, set in a North-South fence.

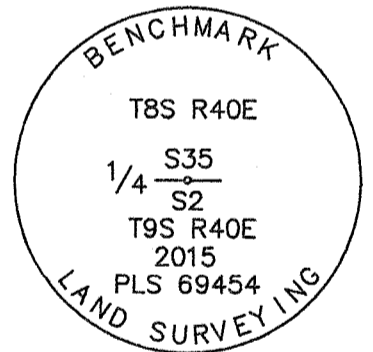

Used RTK GPS to measure the reference points. Bearings are based on Baker County Survey No. 8-40-14.

RESTORATION BY, STAMP AND DATE:

Work Performed December 29, 2015 by:

Jason L. Hatfield, PLS
Michael C. Springer, PLS

BENCHMARK LAND SURVEYING, INC.
2101 Main Street
Baker City, OR 97814
(800) 699-0516
www.benchmarkls.com

FILED January 22, 2016
BAKER COUNTY SURVEYOR
SURVEY NO. 8-40-39
9-40-744

