

# RECORD OF LAND CORNER MONUMENTATION

**CORNER:** SOUTH 1/4 COR. SECTION 35, TWP. 8 S., RANGE 40 E., W.M.

**ORIGINAL SURVEY BY:** Timothy W. Davenport, U.S. Deputy Surveyor

**CONTRACT NUMBER:** 102

**CONTRACT DATE:** July 20, 1863

**SUBSEQUENT SURVEYS:** Baker County Survey No. 9-40-25 by  
James Hanley, PE, filed April 6, 1977

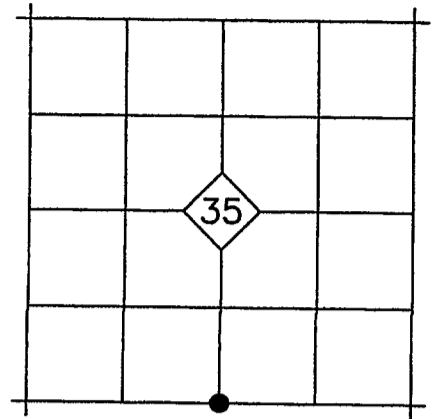

**ORIGINAL DESCRIPTION:** Set qr Sec post and made mound of earth and drove charred stake as per inst.

**SURVEY NO. 9-40-25:** Set 2½" brass cap monument "apportioned location"

**EVIDENCE FOUND:** We found a 1½" pipe with 2½" brass cap from Survey No. 9-40-25 laying on the ground and bent. It appeared that it had been pulled out of the ground by heavy equipment. As there were no references of record for this corner, I reestablished the position by single proportionate measure between the found monument at the southwest corner of Section 35 and the reestablished monument at the Southeast corner of Section 35.

## DESCRIPTION OF MONUMENTS AND ACCESSORIES SET AND METHODS USED:

At the corner point, I set a 5/8"x30" iron pin with attached 2" aluminum cap 30" in the ground. Cap is marked as shown below.

### From which, I SET THE FOLLOWING REFERENCE POINTS:

- ▶ A 5/8"x30" iron pin bears N.59°06'E., 23.05 ft. with attached yellow plastic cap marked BENCHMARK SURVEYING.
- ▶ A 5/8"x30" iron pin bears S.45°06'E., 28.64 ft. with attached yellow plastic cap marked BENCHMARK SURVEYING
- ▶ A 5/8"x30" iron pin bears S.28°58'W., 13.14 ft. with attached yellow plastic cap marked BENCHMARK SURVEYING, in a North-South fence.
- ▶ A 5/8"x30" iron pin bears N.24°01'W., 17.12 ft. with attached yellow plastic cap marked BENCHMARK SURVEYING, set in a North-South fence.

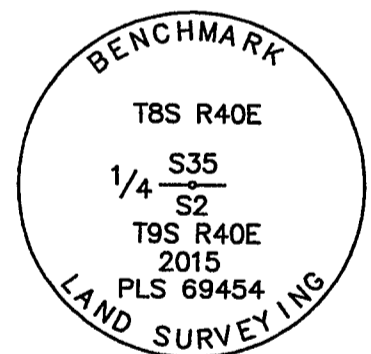

Used RTK GPS to measure the reference points. Bearings are based on Baker County Survey No. 8-40-14.

## RESTORATION BY, STAMP AND DATE:

Work Performed December 29, 2015 by:

Jason L. Hatfield, PLS  
Michael C. Springer, PLS

BENCHMARK LAND SURVEYING, INC.

2101 Main Street  
Baker City, OR 97814  
(800) 699-0516  
www.benchmarkls.com

FILED January 22, 2016  
BAKER COUNTY SURVEYOR  
SURVEY NO. 8-40-39  
9-40-744

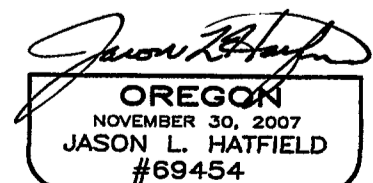

EXPIRES: 6/30/2017