

# RECORD OF LAND CORNER MONUMENTATION

CORNER: CW 1/16 COR. SECTION 35, TWP. 8 S., RANGE 40 E., W.M.

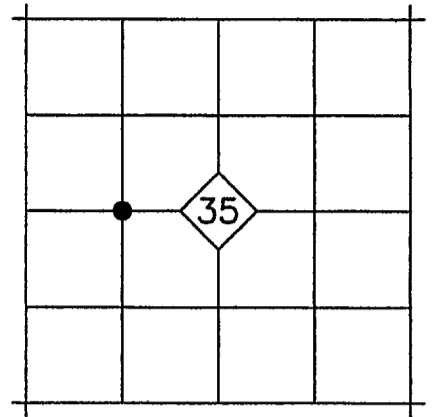

---

**ORIGINAL DESCRIPTION:** N/A

---

**EVIDENCE FOUND:** N/A

---

**DESCRIPTION OF MONUMENTS AND ACCESSORIES SET AND METHODS USED:**

At the corner point, as determined by survey, set a 5/8"x15" iron pin with attached 2" aluminum cap 15" in the ground. Cap is marked as shown below.

From which, **I SET THE FOLLOWING REFERENCE POINTS:**

- ▶ A 5/8"x30" iron pin bears S.24°24'W., 25.01 ft. with attached yellow plastic cap marked BENCHMARK SURVEYING
- ▶ A 5/8"x30" iron pin bears N.82°04'W., 22.85 ft. with attached yellow plastic cap marked BENCHMARK SURVEYING

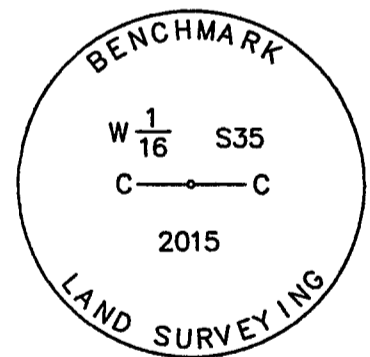

Used RTK GPS to measure the reference points. Bearings are based on Baker County Survey No. 8-40-14.

---

**RESTORATION BY, STAMP AND DATE:**

Work Performed December 29, 2015 by:

Jason L. Hatfield, PLS  
Michael C. Springer, PLS

BENCHMARK LAND SURVEYING, INC.  
2101 Main Street  
Baker City, OR 97814  
(800) 699-0516  
www.benchmarkls.com

FILED January 22, 2016  
BAKER COUNTY SURVEYOR  
SURVEY NO. 8-40-35

