

# RECORD OF LAND CORNER MONUMENTATION

**CORNER:** WEST 1/4 COR. SECTION 35, TWP. 8 S., RANGE 40 E., W.M.

**ORIGINAL SURVEY BY:** David P. Thompson & David Chaplin,  
U.S. Deputy Surveyors

**CONTRACT NUMBER:** 104

**CONTRACT DATE:** April 16, 1864

**SUBSEQUENT SURVEYS:**

Baker County Survey No. 8-40-6 by James Hanley, PLS, filed Nov. 23, 1983

Baker County Survey No. 8-40-10 by James Hanley, PLS, filed Oct. 8, 1985

Baker County Survey No. 8-40-14 by Tom Hanley, PLS, filed Oct. 16, 2001

Baker County Survey No. 8-40-20 by Jason Hatfield, PLS, filed April 23, 2013

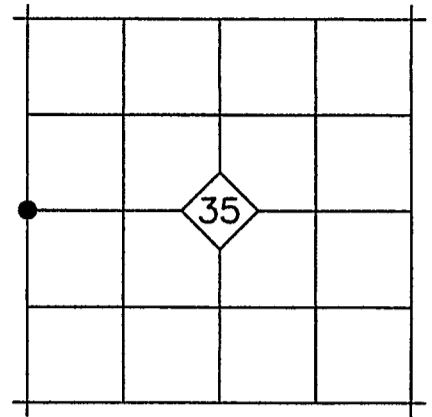

**ORIGINAL DESCRIPTION:** *Set post for 1/4 Sec corner in mound of earth with charred stake pits trench as per instructions.*

Baker County Survey No. 8-40-6: Notation at corner states *Accepted fence intersection as marking the original location of quarter corner. No permanent monument found or set.*

Baker County Survey No. 8-40-10: Notation at corner states *Fence cor.*

Baker County Survey No. 8-40-14: Notation at corner states *Set 12" spike @ fence intersection. Fences run North, South, & East from intersection.*

Baker County Survey No. 8-40-20: *Found bridge spike at base of fence corner as per Record Survey No. 8-40-14*

**EVIDENCE FOUND:** Found bridge spike from Survey No. 8-40-14 at base of corner of fences running North, East and South. I accept the spike for the position of the 1/4 Corner.

**DESCRIPTION OF MONUMENTS AND ACCESSORIES SET AND METHODS USED:**

I remove the found bridge spike, and in its place set a 5/8"x30" iron pin with attached 2" aluminum cap 30" in the ground. Cap is marked as shown below.

**From which, I SET THE FOLLOWING REFERENCE POINTS:**

- ▶ A 5/8"x30" iron pin bears N.88°00'E., 29.42 ft. with attached yellow plastic cap marked BENCHMARK SURVEYING, set in an East-West fence.
- ▶ A 5/8"x30" iron pin bears South, 15.12 ft. with attached yellow plastic cap marked BENCHMARK SURVEYING, set in a North-South fence.
- ▶ A 5/8"x30" iron pin bears N.67°24'W., 7.87 ft. with attached yellow plastic cap marked BENCHMARK SURVEYING
- ▶ A 5/8"x30" iron pin bears N.05°49'W., 25.02 ft. with attached yellow plastic cap marked BENCHMARK SURVEYING, set in a North-South fence.

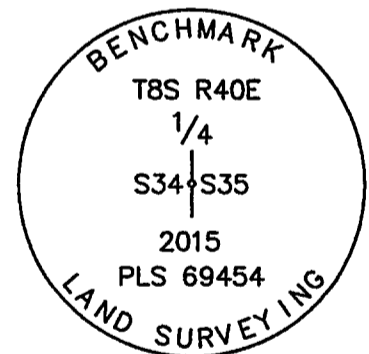

Used RTK GPS to measure the reference points. Bearings are based on Baker County Survey No. 8-40-14.

**RESTORATION BY, STAMP AND DATE:**

Work Performed December 29, 2015 by:

Jason L. Hatfield, PLS  
Michael C. Springer, PLS

BENCHMARK LAND SURVEYING, INC.

2101 Main Street  
Baker City, OR 97814  
(800) 699-0516  
www.benchmarkpls.com

FILED January 22, 2016  
BAKER COUNTY SURVEYOR  
SURVEY NO. 8-40-34

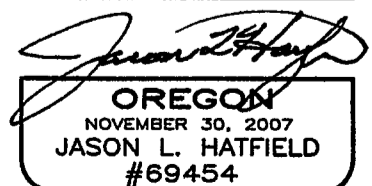
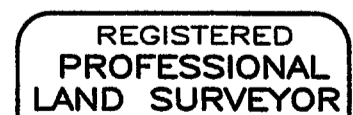

EXPIRES: 6/30/2017