

# RECORD OF LAND CORNER MONUMENTATION

CORNER: NW 1/16 COR. SECTION 35, TWP. 8 S., RANGE 40 E., W.M.

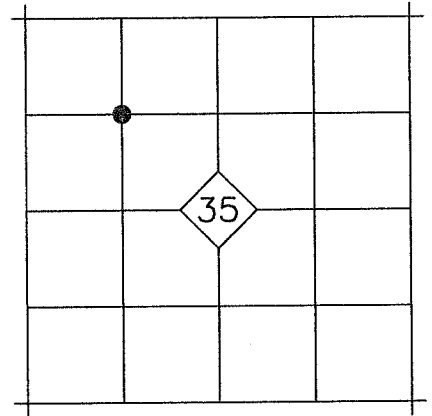

ORIGINAL DESCRIPTION: N/A

EVIDENCE FOUND: N/A

### DESCRIPTION OF MONUMENTS AND ACCESSORIES SET AND METHODS USED:

At the corner point, as determined by survey, set a 5/8"x30" iron pin with attached 2" aluminum cap 29" in the ground. Cap is marked as shown below.

From which, I SET THE FOLLOWING REFERENCE POINTS:

- ▶ A 5/8"x30" iron pin bears S.17°24'W., 17.52 ft. with attached yellow plastic cap marked BENCHMARK SURVEYING
- ▶ A 5/8"x30" iron pin bears N.29°54'W., 13.49 ft. with attached yellow plastic cap marked BENCHMARK SURVEYING

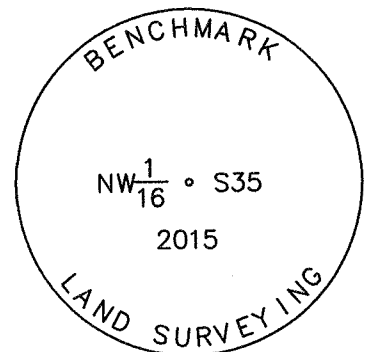

Used RTK GPS to measure the reference points. Bearings are based on Baker County Survey No. 8-40-14.

### RESTORATION BY, STAMP AND DATE:

Work Performed December 29, 2015 by:

Jason L. Hatfield, PLS  
Michael C. Springer, PLS

BENCHMARK LAND SURVEYING, INC.  
2101 Main Street  
Baker City, OR 97814  
(800) 699-0516  
www.benchmarkls.com

FILED January 22, 2016  
BAKER COUNTY SURVEYOR  
SURVEY NO. 8-40-32

