

RECORD OF LAND CORNER MONUMENTATION

CORNER: N1/16 COR. SECTIONS 34 & 35, TWP. 8 S., RANGE 40 E., W.M.

(CORNER NOT PREVIOUSLY ESTABLISHED)

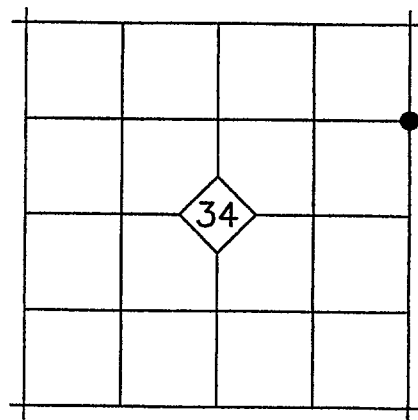

ORIGINAL DESCRIPTION: N/A

EVIDENCE FOUND: N/A

DESCRIPTION OF MONUMENTS AND ACCESSORIES SET AND METHODS USED:

At the corner point, as determined by survey, set a 5/8"x10" iron pin with attached 2" aluminum cap 11" in the ground. Top of cap is 1" below road surface. Cap is marked as shown below.

From which, I SET THE FOLLOWING REFERENCE POINTS:

- ▶ A 5/8"x30" iron pin bears N.72°57'E., 17.84 ft. with attached yellow plastic cap marked BENCHMARK SURVEYING
- ▶ A 5/8"x30" iron pin bears S.73°46'W., 20.68 ft. with attached yellow plastic cap marked BENCHMARK SURVEYING

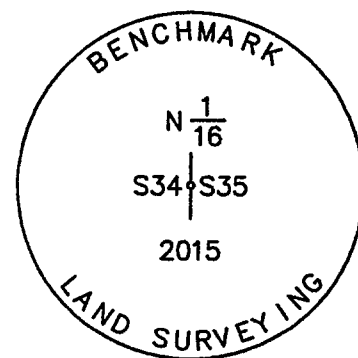

Used RTK GPS to measure the reference points. Bearings are based on Baker County Survey No. 8-40-14.

RESTORATION BY, STAMP AND DATE:

Work Performed December 29, 2015 by:

Jason L. Hatfield, PLS
Michael C. Springer, PLS

BENCHMARK LAND SURVEYING, INC.

2101 Main Street
Baker City, OR 97814
(800) 699-0516
www.benchmarkls.com

REU January 22, 2016
BAKER COUNTY SURVEYOR
SURVEY NO. 8-40-31

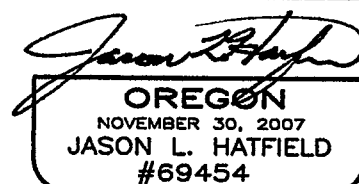

EXPIRES: 6/30/2017