

RECORD OF LAND CORNER MONUMENTATION

CORNER: NE 1/16 COR. SECTION 34, TWP. 8 S., RANGE 40 E., W.M.

ORIGINAL SURVEY BY: James Hanley, PLS

BAKER COUNTY SURVEY NUMBER: 8-40-10

FILING DATE: October 8, 1985

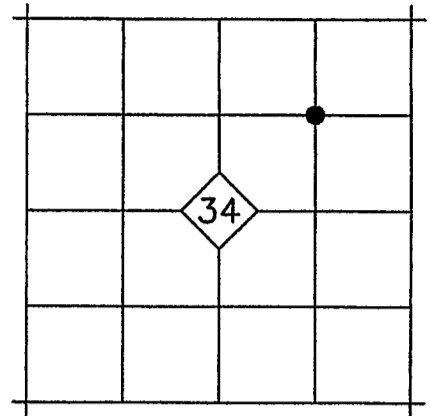

ORIGINAL DESCRIPTION: Set 5/8"x30" rebar with plastic cap mkd. "HANLEY ENGR. PLS 1206"

EVIDENCE FOUND: Found 5/8" iron pin with yellow plastic cap from Survey No. 8-40-10, which bears South 3.5 feet from corner, and is not accepted. See Map of Survey dated December 31, 2015, filed separately for details.

DESCRIPTION OF MONUMENTS AND ACCESSORIES SET AND METHODS USED:

At the corner point, as determined by survey, set a 5/8"x30" iron pin with attached 2" aluminum cap 29" in the ground. Cap is marked as shown below.

From which, I SET THE FOLLOWING REFERENCE POINTS:

- ▶ A 5/8"x30" iron pin bears S.50°33'E., 39.47 ft. with attached yellow plastic cap marked BENCHMARK SURVEYING
- ▶ A 5/8"x30" iron pin bears S.31°17'E., 45.04 ft. with attached yellow plastic cap marked BENCHMARK SURVEYING

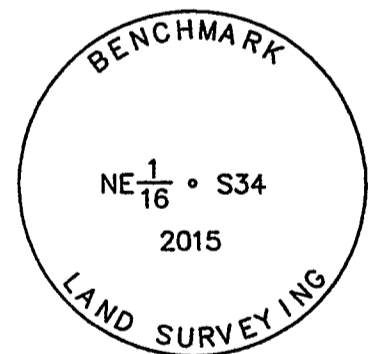

Used RTK GPS to measure the reference points. Bearings are based on Baker County Survey No. 8-40-14.

RESTORATION BY, STAMP AND DATE:

Work Performed December 29, 2015 by:

Jason L. Hatfield, PLS
Michael C. Springer, PLS

BENCHMARK LAND SURVEYING, INC.
2101 Main Street
Baker City, OR 97814
(800) 699-0516
www.benchmarkls.com

FILED January 22, 2016
BAKER COUNTY SURVEYOR
SURVEY NO. 8-40-30

