

# CORNER RESTORATION

**CORNER:** S1/16 SEC. 34 TWP. 8 S. RANGE 40 E., W.M.

**ORIGINAL SURVEY BY:** CORNER NOT

**CONTRACT NUMBER:** PREVIOUSLY

**CONTRACT DATE:** ESTABLISHED

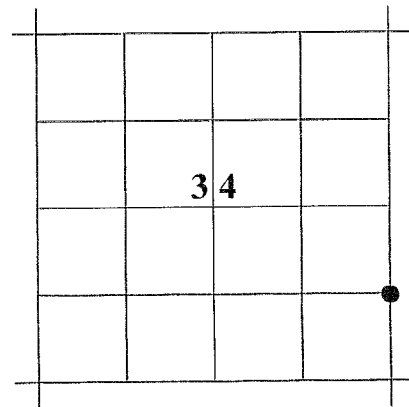

---

**ORIGINAL DESCRIPTION:** NONE

---

**EVIDENCE FOUND:** NONE

---

**DESCRIPTION OF MONUMENT AND ACCESSORIES:**

At the corner point as located by survey, I set a 5/8"x30" iron pin with attached 2" aluminum cap, 29" in the ground, surrounded with a small mound of stone. Aluminum cap is marked as shown below.

**From which, I SET THE FOLLOWING REFERENCE POINTS:**

- ▶ A 5/8"x30" iron pin bears S.01°34'50"E., 24.95 ft., with attached yellow plastic cap marked "BENCHMARK SURVEYING"
- ▶ A 5/8"x30" iron pin bears S.45°02'W., 20.00 ft., with attached yellow plastic cap marked "BENCHMARK SURVEYING"

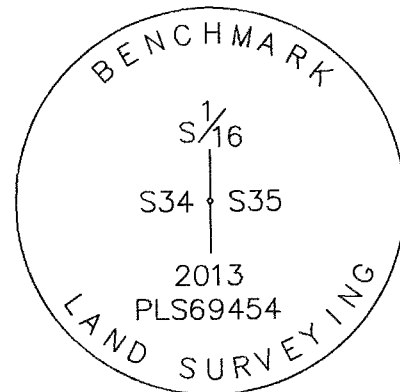

Used RTK GPS to measure RP's.

---

**RESTORATION BY, STAMP AND DATE:**

Jason L. Hatfield, PLS

Benchmark Land Surveying  
2101 Main Street, Suite 223  
Baker City, OR 97814

April 18, 2013

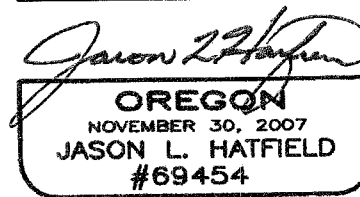
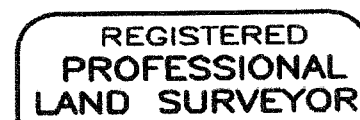

EXPIRES: 6/30/2013

SEE RECORD MAP OF SURVEY DATED APRIL 18, 2013, FILED SEPARATELY

FILED Apr 23 2013  
BAKER COUNTY SURVEYOR  
SURVEY NO. 8-40-21

Y-17  
T-8