

**BASIS OF BEARINGS**  
 RECORD SURVEY NO. 8-40-14  
 THE WEST LINE OF THE SE1/4SE1/4 SEC. 34 BETWEEN  
 FOUND MONUMENTS BEARS N01°36'00"W AS SHOWN

**NARRATIVE**

THIS SURVEY WAS PERFORMED AT THE REQUEST OF JOHN OSBORN. THE PURPOSE OF THIS SURVEY WAS TO LOCATE AND MONUMENT THE PROPOSED PROPERTY LINE ADJUSTMENT AS SHOWN HEREON.  
 A SEARCH WAS MADE OF THE AVAILABLE RECORDS PERTAINING TO THIS SURVEY. FIELD MEASUREMENTS WERE MADE TO LOCATE APPURTENANT MONUMENTS SHOWN ON SURVEY NO.'S 8-40-10, 8-40-14, 9-40-539MP AND 9-40-617.

THE 8 ACRE PORTION OF THE SUBJECT PROPERTY SITUATED IN THE NE1/4NE1/4 SECTION 3 WAS ORIGINALLY BROKEN OFF FROM, AND IS SENIOR TO, THE REMAINING LAND IN SAID NE1/4NE1/4 SECTION 3 AS EVIDENCED BY DEED RECORD BOOK 64 PAGES 614 AND 616. THE DESCRIPTION STATES (IN PART): "...AND 8 ACRES OFF OF THE NORTH SIDE OF THE NE1/4 OF NE1/4..." AND GOES ON TO DESCRIBE IT BY METERS AND BOUNDS, USING CARDINAL DIRECTIONS AND DISTANCES TO THE NEAREST ROD, ASSUMING A "NEAT" SECTION SUBDIVISION. I BELIEVE IT WAS THE INTENT OF THE ORIGINAL GRANTOR TO CONVEY EIGHT ACRES, WHEREBY THE DIMENSIONS YIELD TO THE AREA.

I FOUND THE MONUMENTS FROM SAID SURVEY'S WITHIN TOLERANCE AND I ACCEPT THEIR POSITIONS, AS SHOWN. I SET NEW MONUMENTS AT LOCATIONS APPROVED BY MR. OSBORN AND ACCORDING TO THE EVIDENCE FOUND AND THE DEED AND SURVEY RECORD, AS SHOWN HEREON. ALSO SEE THE CORNER RESTORATION REPORT FILED SEPARATELY FOR THE 1/16TH CORNER SET DURING THIS SURVEY, WHICH PROVIDES MORE DETAILS REGARDING THE NEW MONUMENT AND ITS ACCESSORIES.

**REFERENCES**

- RECORD MAP OF SURVEY NO.'S 8-40-10, 8-40-14, 9-40-539MP AND 9-40-617
- DEED RECORD BOOK 64, PAGES 313-316
- DEED RECORD INSTRUMENT NO.'S 92 40 057, B05 28 0354 B07 09 0272 AND B0111 0017
- AMERITITLE ORDER NO. 30640

**LEGEND**

- FOUND 1/2" GALV. IRON PIPE WITH ATTACHED 2 1/2" BAKER COUNTY SURVEYOR BRASS CAP DATED 1977 SHOWN ON SURVEY NO. 8-40-10
- FOUND 5/8" IRON PIN WITH ATTACHED YELLOW PLASTIC CAP MARKED "HANLEY ENGR. PLS 1817" AS PER RECORD SURVEY NO. 8-40-14
- ◆ FOUND BRIDGE SPIKE AT BASE OF FENCE CORNER AS PER RECORD SURVEY NO. 8-40-14
- ⊙ SET 5/8"x30" IRON PIN WITH ATTACHED 2" ALUMINUM CAP MARKED BENCHMARK LAND SURVEYING, AND WITH APPROPRIATE 1/16 CORNER DESIGNATION
- SET 5/8"x30" IRON PIN WITH ATTACHED YELLOW PLASTIC CAP MARKED BENCHMARK SURVEYING
- ( ) DEED RECORD BEARING AND DISTANCE
- [ ] RECORD BEARING AND DISTANCE FROM SURVEY NO. 8-40-14
- 1[ ] RECORD BEARING AND DISTANCE FROM SURVEY NO. 9-40-539MP
- 2[ ] RECORD BEARING AND DISTANCE FROM SURVEY NO. 9-40-617

REGISTERED  
 PROFESSIONAL  
 LAND SURVEYOR  
  
 OREGON  
 NOVEMBER 30, 2007  
 JASON L. HATFIELD  
 #69454  
 EXPIRES: 6/30/2013

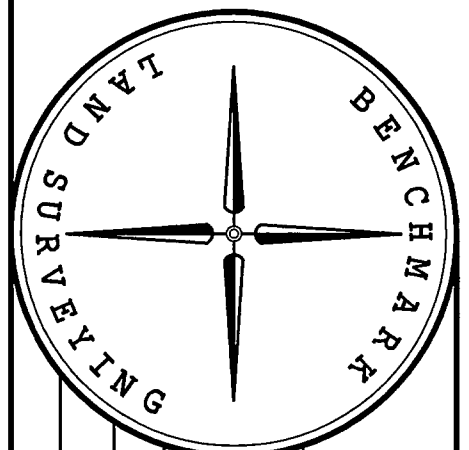

BENCHMARK LAND SURVEYING  
 217 N. CANYON BLVD. JOHN DAY, OREGON  
 2101 MAIN STREET, STE 223 BAKER CITY, OREGON  
 541-575-1251 ~ 800-699-0516

MAP OF SURVEY  
 PROPOSED PROPERTY LINE ADJUSTMENT  
 SITUATED IN THE SE1/4 SECTION 34, T.8S., R.40E. AND IN THE  
 NE1/4 SECTION 3, T.9S., R.40E., W.M.,  
 BAKER COUNTY, OREGON

SURVEYED FOR	JOHN OSBORN, JR.
SURVEYED BY	JLH
SCALE: 1"=400'	DRAWN BY: JLH
	4/19/2013

FILED APR 23, 2013  
 BAKER COUNTY SURVEYOR  
 SURVEY NO. 8-40-20  
 9-40-710A