

RECORD OF LAND CORNER MONUMENTATION

CORNER: CENTER-EAST 1/16 COR. SECTION 20, T. 8 S., R. 39 E., W.M.

PREVIOUSLY ESTABLISHED BY: James Hanley, P.E.
Summerfield West Subdivision
Baker County Survey No. 8-46-58
Filed in the County Surveyor's records
January 15, 1996

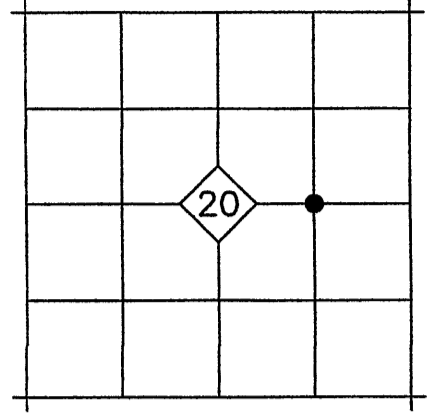

HANLEY'S DESCRIPTION: Notation at corner: *"SPIKE 1" BELOW ROAD SURFACE"*

EVIDENCE FOUND: I searched for but did not find the spike.

DESCRIPTION OF MONUMENTS AND ACCESSORIES SET AND METHODS USED:

At the midpoint between found accepted monuments, I set a 5/8"x24" iron pin with attached 2" aluminum cap 27" in the ground. Cap is marked as shown below.

From which, I UTILIZED THE FOLLOWING MONUMENTS AS REFERENCE POINTS:

- ▶ A 5/8" iron pin with no cap, set during the survey for Summerfield West Subdivision, bears S.00°04'36"W., 30.00 ft.
- ▶ A 5/8"x30" iron pin bears S.75°21'35"W., 120.20 ft. with attached yellow plastic cap marked BENCHMARK SURVEYING.

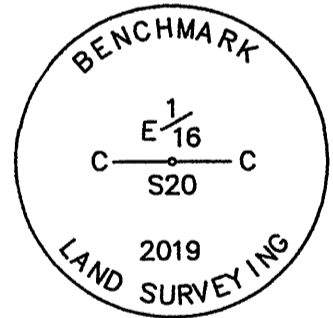

Used RTK GPS to measure the reference points. Bearings are based on associated Land Partition dated September 23, 2019.

Work Performed September 23, 2019 by:

Jason L. Hatfield, PLS

BENCHMARK LAND SURVEYING, INC.
1207 Dewey Avenue
Baker City, OR 97814
(541) 523-5852
www.benchmarkls.com

FILED December 9, 2019
BAKER COUNTY SURVEYOR
SURVEY NO. 8-39-130

REGISTERED
PROFESSIONAL
LAND SURVEYOR

OREGON
NOVEMBER 30, 2007
JASON L. HATFIELD
#69454

EXPIRES: 6/30/2021