

CORNER RESTORATION

CORNER: W1/4 Cor. SEC. 27 TWP. 8 S. RANGE 39 E.

ORIGINAL SURVEY BY: D.P Thompson & D. Chaplin

CONTRACT NUMBER: 104

CONTRACT DATE: April 16, 1864

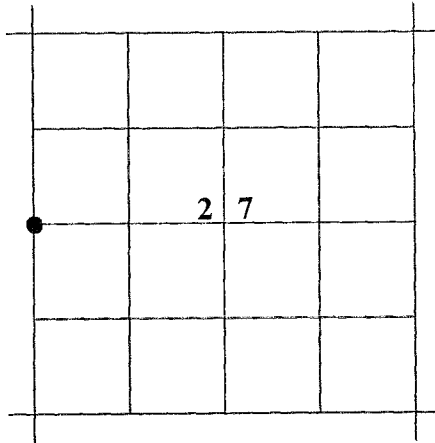

Corner was subsequently established by James Hanley in Survey No. 8-39-21

ORIGINAL DESCRIPTION: Set post for 1/4 Sec corner in mound of earth with charred stake, pits trenched as per instructions.

SURVEY NO. 8-39-21: Performed by James Hanley, PLS in 1975. Mr. Hanley re-set this corner at the intersection of the centerline of Wingville Lane and a fence running north.

RESTORATION BY, STAMP AND DATE:

Michael C. Springer, PLS
Jason L. Hatfield, PLS

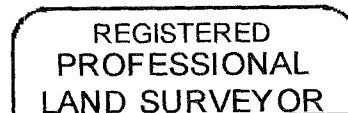

MCS
OREGON
JULY 9, 2002
MICHAEL C. SPRINGER
#70918

EXPIRES: 6/30/2010

May 22, 2009

EVIDENCE FOUND: After a diligent search, we found no evidence of the original GLO corner or Hanley's corner. I determine this corner to be lost. I re-establish this corner at the intersection of the centerline of Wingville Lane and the west line of Section 27, between the monuments at the NW and SW corners of said Section 27.

DESCRIPTION OF MONUMENTS AND ACCESSORIES SET AND METHODS USED:

At the corner point: I set a 5/8"x30" iron pin, 31" in the ground (approximately 1" below the road surface), with attached 2" aluminum cap marked as shown

FROM WHICH I SET THE FOLLOWING NEW REFERENCE POINTS:

A 5/8"x30" iron pin, bears N38°11'30"E, 38.81 ft., with attached 1-1/2" aluminum cap marked "BMLS SURVEY MARKER RP1 2009" pin is in an E-W fence.

A 5/8"x30" iron pin, bears S63°52'10"E, 40.82 ft., with attached 1-1/2" aluminum cap marked "BMLS SURVEY MARKER RP2 2009"

A 5/8"x30" iron pin, bears S21°58'20"W, 15.67 ft., with attached 1-1/2" aluminum cap marked "BMLS SURVEY MARKER RP3 2009"

A 5/8"x30" iron pin, bears N46°50'30"W, 44.77 ft., with attached 1-1/2" aluminum cap marked "BMLS SURVEY MARKER RP4 2009" pin is in an E-W fence.

Used RTK GPS to measure to RP's. The bearings shown hereon are based on the record survey for Steve Feiling and Wayne Lewis filed in the office of the Baker County Surveyor.

FILED June 25, 2009

T-13

BAKER COUNTY SURVEYOR

SURVEY NO. 8-39-24 109

