

CORNER RESTORATION

CORNER: N1/16 Cor. SEC. 27 TWP. 8 S. RANGE 39 E.

ORIGINAL SURVEY BY: CORNER

CONTRACT NUMBER: NOT PREVIOUSLY

CONTRACT DATE: ESTABLISHED

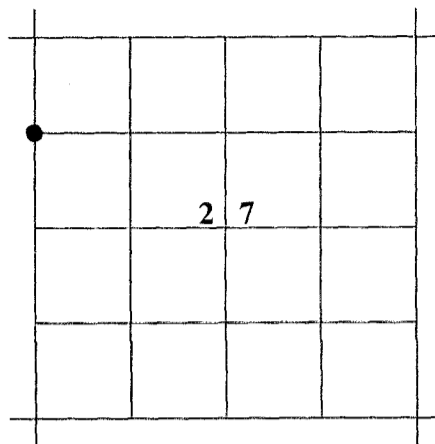

ORIGINAL DESCRIPTION: Corner not previously established

RESTORATION BY, STAMP AND DATE:

Michael C. Springer, PLS
Jason L. Hatfield, PLS

REGISTERED
PROFESSIONAL
LAND SURVEYOR

OREGON
JULY 9, 2002
MICHAEL C. SPRINGER
#70918

EXPIRES: 6/30/2010

May 22, 2009

EVIDENCE FOUND: None. Set corner at mid-point between the established NW Corner and SW Corner of Section 27.

DESCRIPTION OF MONUMENTS AND ACCESSORIES SET AND METHODS USED:

At the corner point: I set a 5/8"x30" iron pin, 31" in the ground, with attached 2" aluminum cap marked as shown

FROM WHICH I SET THE FOLLOWING NEW REFERENCE POINTS:

A 5/8"x30" iron pin, bears N56°30'40"E, 30.30 ft., with attached 1-1/2" yellow plastic cap marked "BENCHMARK SURVEYING". Pin is in an E-W fence.

A 5/8"x30" iron pin, bears S03°17'00"E, 29.17 ft., with attached 1-1/2" yellow plastic cap marked "BENCHMARK SURVEYING". Pin is in a N-S fence.

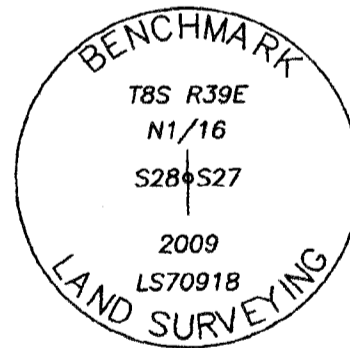

Used RTK GPS to measure to RP's. The bearings shown hereon are based on the record survey for Steve Feiling and Wayne Lewis filed in the office of the Baker County Surveyor.

FILED June 25, 2009

BAKER COUNTY SURVEYOR

SURVEY NO. B-39-25100

S-13