

CERTIFIED RECORD OF LAND CORNER MONUMENTATION

History of original corner establishment:

Corner established by John Hagel, U.S. Deputy Mineral Surveyor, under instructions received from the United States Surveyor General for Oregon dated Oct. 19, 1899, and designated as Survey No. 378.

Surveyor General records state:

Identical with the SE location Cor., identical with Cor. No. 1 Telephone Lode. Set a tamarack post, 4 ins. square, 4 1/2 ft. long, 18 ins. in the ground, with a mound of earth around it, marked Charl. C. 6-378 Tel. C. 1-378.

A tamarack tree, 8 ins. in diam., bears S66°35'W, 57.6 ft.
A tamarack tree, 12 ins. in diam., bears S44°E, 13.0 ft.
Both blazed and marked Charl. C. 6-378 BT.

Corner was reestablished by: Leland Myers, per Baker County Survey 8-37-135/9-37-279 in 2003. No Corner Record for this Monument was found. The Survey does not describe how he reestablished the position.

Description of corner evidence found:

A 1 inch galv. iron pipe with a 2 1/2 inch brass cap, marked as shown. Firmly set 2 inches above ground.

From which:

A stump hole (by Hagel), bears S44°E, 13.0 ft.

A 24 inch tamarack (by Myers) with healed blaze, bears S37°E, 25.4 ft to a 1 1/2 inch SS washer mkd: PLS 699 in right side center, alive & healthy.

A 9 inch white fir (by Myers) with healed blaze, bears S42°W, 9.6 feet to a 1 1/2 inch SS washer mkd: PLS 699 in right side center, alive & healthy.

A 2 1/2 inch brass cap mkd: TEL 1, bears S28 1/2°E, 9.42 ft.

Monument falls West 640 feet from Fruit Creek Road; approximately 3,500 feet northerly of the intersection with NF-5540 Road.

Description of monument and accessories I established to perpetuate original location of this corner:

Added Bearing Tree and Land Survey Monument signs as needed.

NAD 83 Geodetic Position

Lat. 44°49'07.6" N
Long. 118°12'45.4" W

Established by: Garmin ETREX 32x

I hereby certify that the corner is monumented and accessories taken as described using a steel tape and a Warren Knight staff compass, set with a declination of 14° East.

Witnesses: David Quittschreiber, Justin Seal

September 21, 2023

T 8 S R 37 E
MS 378
6 CH

CHARLESTON
Cor. 6

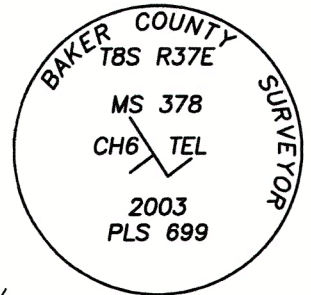

REGISTERED
PROFESSIONAL
LAND SURVEYOR

Kristina Powell

OREGON
MAY 9, 2017
KRISTINA POWELL
91201

EXPIRES 12-31-24

FILED January 8, 2024
BAKER COUNTY SURVEYOR
SURVEY NO. 8-37-183