

# RECORD OF LAND CORNER MONUMENTATION

EAST 1/4 CORNER SECTION 33, T. 8 S., R. 37 E., W.M.

29	28	28	27
32	33	33	34
32	33	33	34

**ORIGINALLY ESTABLISHED BY:** Lincoln E. Wilkes, U.S. Cadastral Engineer

**GROUP NUMBER:** 107

**APPROVAL DATE:** May 26, 1927

**SUBSEQUENT SURVEYS:** Corner maintenance activities performed September 20, 1985 by William L. Hanley, PLS #1639, as evidenced by the Certified Record of Land Corner Monumentation filed February 5, 1986, as Baker County Survey No. 8-37-86

**ORIGINAL DESCRIPTION:** Set an iron post, 3 ft. long, 1 in. dia, 27 ins. in the ground, for 1/4 sec. cor., with brass cap marked (diagram shown) from which  
 A balsam, 8 ins. dia., bears N. 26° E., 20 lks. dist., marked 1/4 S 34 BT.  
 A balsam, 7 ins. dia., bears N. 80° W., 25 lks. dist., marked 1/4 S 33 BT.

**HANLEY'S DESCRIPTION:**

A brass cap of record dimensions and markings as shown in the corner diagram.

A leaning alpine fir snag 8 ins dia bears N80°W, 25 lks marked 1/4S33BT on decomposing open face.  
 An alpine fir snag 17 ins dia bears N02°E, (record states N26°E) 35.5 ft (record states 20 lks) with typical healed blaze.

Improved surrounding rock mound around recovered corner monument and set a 6 foot steel fence post alongside with a sign 54-9 attached.

New bearing trees established:

- An alpine fir 7 ins dia bears N52°W, 2.8 ft dist marked 1/4S33BT.
- An alpine fir 12 ins dia bears N20°E, 21.5 ft dist marked 1/4S34BT.

**EVIDENCE FOUND:** Found 1" iron pipe with 2 1/2" brass cap, marked as shown below, projecting 16" above ground in a 2.5 ft. diameter mound of stone, with a steel fence post with attached USFS 54-9 sign set westerly, 4 ft. from the found monument.  
 All bearing trees are dead and down.

**DESCRIPTION OF MONUMENTS AND ACCESSORIES SET AND METHODS USED:**

I accept the position of the found monument for the corner.

From which, **I SCRIBE NEW BEARING TREES:**

- ▶ A fir, 10" dbh, bears N.48°E., 31.00 ft. marked X in upper blaze, and BT in lower blaze.
- ▶ A fir, 11" dbh, bears S.72°E., 32.00 ft. marked 1/4S34 in upper blaze, and BT in lower blaze.
- ▶ An Engelmann spruce, 12" dbh, bears S.82°W., 17.46 ft. marked 1/4S33 in upper blaze, and BT in lower blaze.
- ▶ An Engelmann spruce, 15" dbh, bears N.21°W., 63.95 ft. marked X in upper blaze, and BT in lower blaze.

CORNER MONUMENT MARKED:

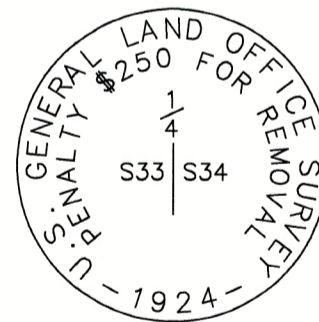

Painted a 6 inch red band around each bearing tree, and also painted the blazes red. Attached USFS 54-3 and 54-9 signs to BT's. Used magnetic compass with 14° East declination to measure bearings. Used an EDM device to measure distances to new bearing trees, measuring to a 60d nail driven in the side-center-right at the root crown of each tree, with an attached 1 1/2" aluminum washer stamped PLS 69454.

**RESTORATION BY, STAMP AND DATE:**

Work performed July 5, 2023  
 Survey completed October 17, 2023

Toribio J. Quinones, LSIT  
 Daniel B. Lee, Survey Tech

USDA FOREST SERVICE  
 NORTHEAST OREGON LAND ZONE  
 1550 Dewey Avenue, Suite A  
 Baker City, OR 97814  
 (541) 523-1283

FILED December 20, 2023  
 BAKER COUNTY SURVEYOR  
 SURVEY NO. 8-37-166



EXPIRES: 6/30/2025